

G435 SE

SETUP GUIDE | 设置指南





ENGLISH	3
简体中文	13
繁體中文	23
한국어	33

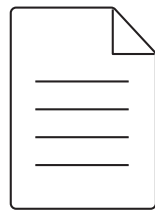
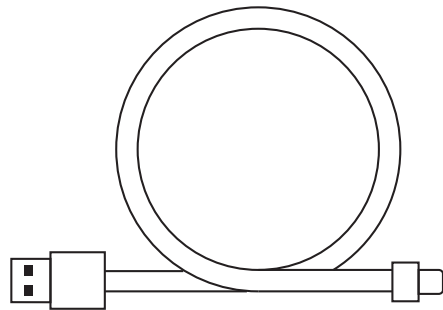
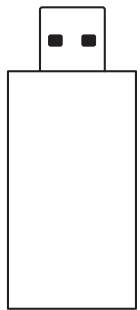

CLEANING THE LOGITECH G435 SE

In the event your Logitech G435 SE needs cleaning we have some recommendations:

Before You Clean

- Do not wash your ear pads in a washing machine
- Do not dry your ear pads in a tumble dryer
- Don't put cleaning liquids directly on your ear pads and headband.
- Don't use bleach, acetone/nail polish remover, strong solvents, or abrasives as it might affect the polyester fabric surface condition and cause discoloration.
- When using cleaning sprays, spray on the cloth and wipe — do not spray the product directly.

Wiping and Cleaning Your G435 SE

- To wipe or clean the headset, use regular tap water to lightly moisten a clean, soft, lint-free cloth and gently wipe down the headband and ear pads.
- For heavier stains, you might additionally use a small amount of soap on the lightly moisten, clean, soft cloth and gently rub stained areas. Rinse thoroughly the surface by using the same moisten cloth. Repeat until all traces of soap are gone.
- You can also use fragrance-free disinfecting wipes, fragrance-free anti-bacterial wet wipes.
- Let it dry at room temperature.

Logitech encourages users to properly sanitize their products in accordance with guidelines put out by the World Health Organization and the Centers for Disease Control guidelines.

CONNECTING YOUR HEADSET USING LIGHTSPEED

Connect to your PC, Mac, PlayStation 5 or 4 with LIGHTSPEED Wireless Technology

- Insert receiver into the USB port of your device.

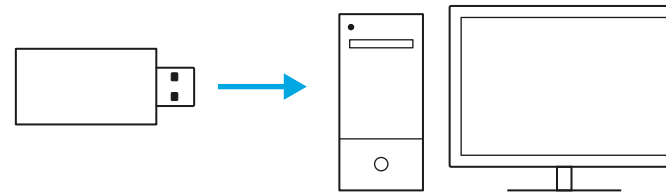

- Press the Power button for minimum 1.5 sec.
- The LED turns cyan once connected.

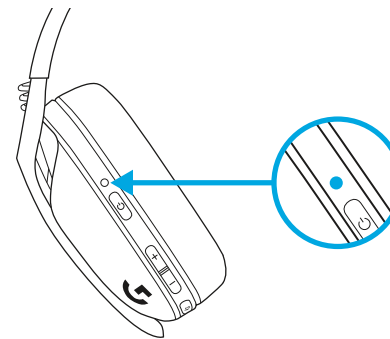
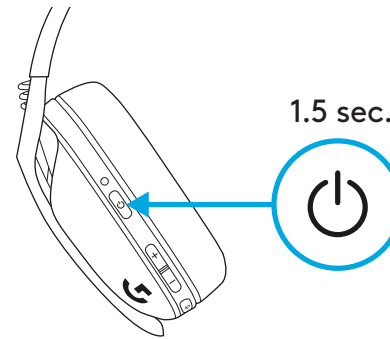

HOW TO CONNECT YOUR G435 SE USING *BLUETOOTH*

- Press Power+Mute buttons for 3 seconds or longer.

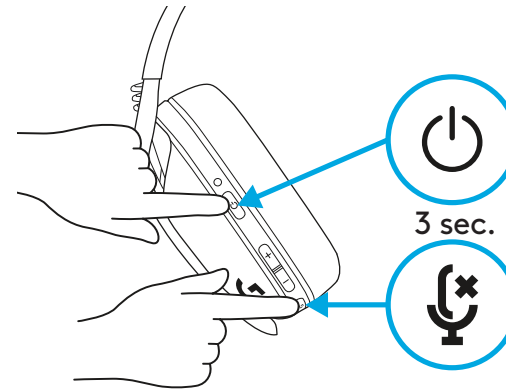

- LED will flash **blue** as it enters pairing mode.

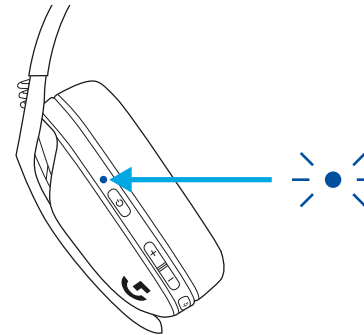

- Look for G435 SE under the *bluetooth* list of your device and connect.
- Note: G435 SE can connect to a single *Bluetooth* device at a time.

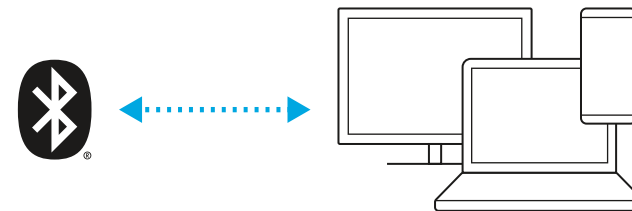

HOW TO SWITCH THE CONNECTION MODE BETWEEN LIGHTSPEED AND *BLUETOOTH* ON G435 SE

- Press the Mute button for 3 seconds or longer.

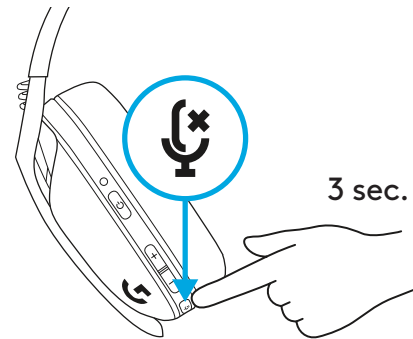

- Switch to LIGHTSPEED, LED will light cyan for 5 seconds.

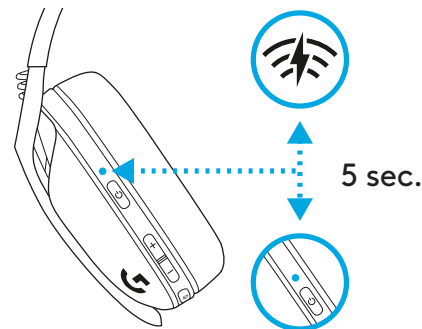

- Switch to *Bluetooth*, LED will light blue for 5 seconds.

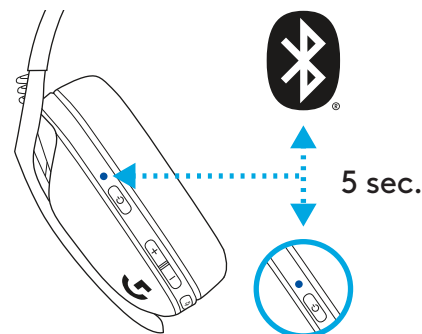

HOW TO POWER ON AND OFF YOUR G435 SE

Power ON

- Press the Power button for 1.5 seconds when the headset is OFF.

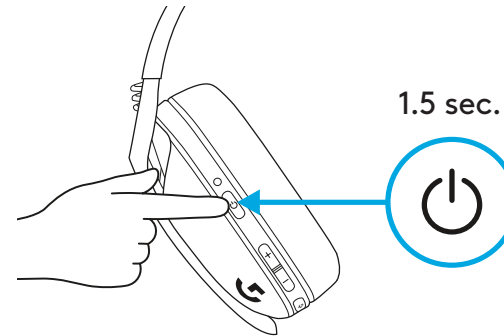

Power OFF

- Press the Power button for 3 seconds when the headset is ON.

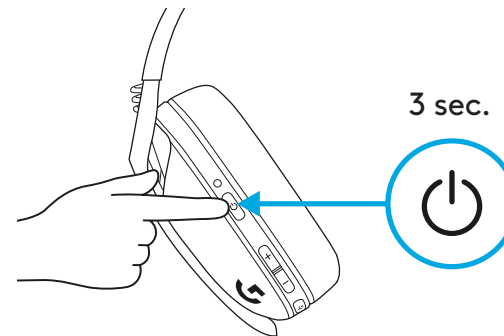

Auto Shutoff

- G435 SE automatically shuts off after 30 minutes of inactivity.

HOW TO TOGGLE MUTE / UNMUTE AND MAX VOLUME ON YOUR G435 SE

MUTE / UNMUTE microphone

- Short press on the Mute button.

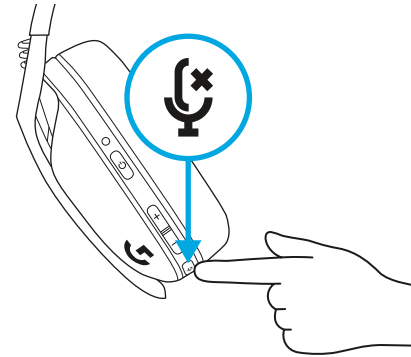

Set Max Volume

- Set to 100 dB
 - Press Mute button + Volume UP for 3 seconds or longer.
 - The LED will flash orange 3 times.

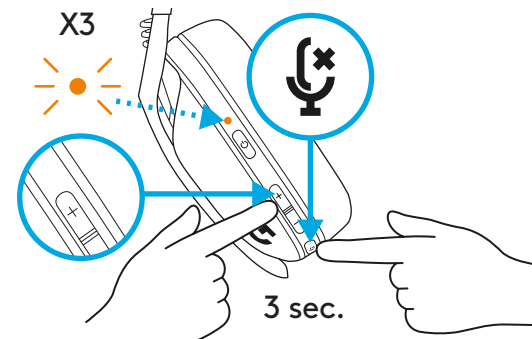

- Set to 85 dB
 - Press Mute button + Volume DOWN for 3 seconds or longer.
 - LED will turn solid orange for 5 seconds.

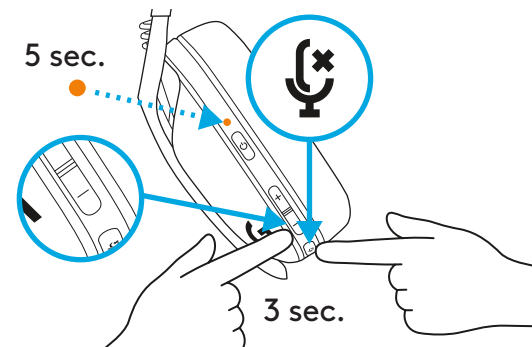

CHECK YOUR BATTERY LEVEL OF YOUR G435 SE

- Single press the Power button, when headset is ON

- LED will show **green** for 5 seconds, which means Battery is between 31% to 100%.

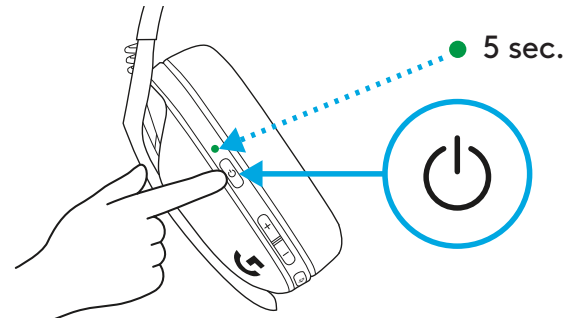

- LED will show **red** for 5 seconds, which means Battery is between 15% to 30%.

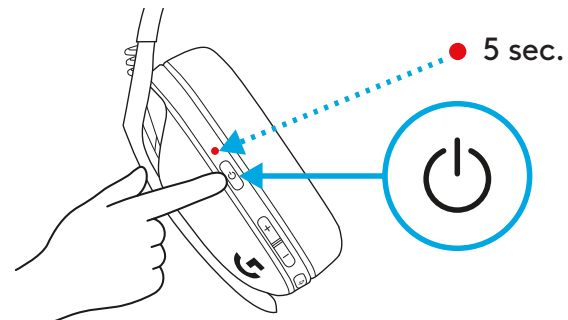

- LED will flash **red** for 5 seconds, which means Battery level is <15%.

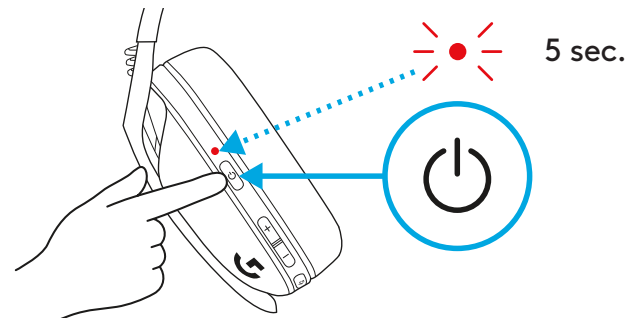

SET THE SIDETONE ON YOUR G435 SE

Sidetone lets you hear your voice while communicating with other people. It mirrors the experience of talking on a phone and allows you to adjust your speaking volume to a proper level.

- Enable Sidetone

- Double press the Mute button and the LED will flash twice in **orange**.

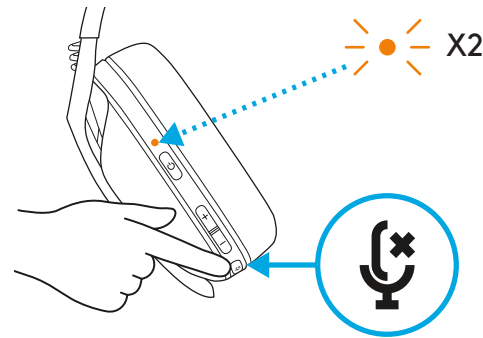

- Disable Sidetone

- Double press the Mute button and the LED will flash once in **orange**.

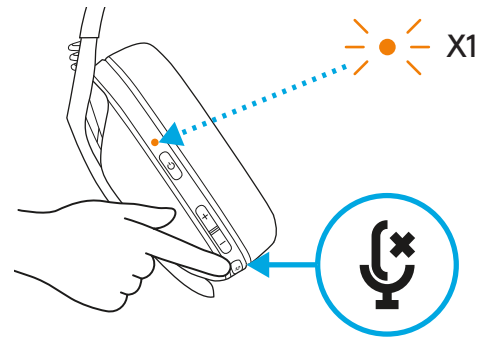

- Adjust Sidetone

- UP = Single press Mute button + Volume UP.

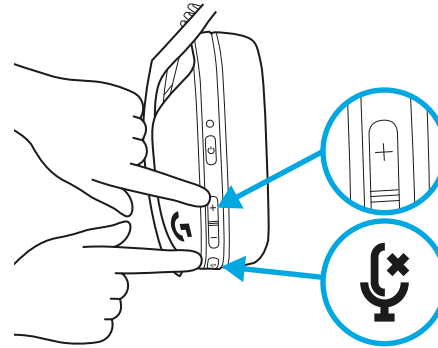

- DOWN = Single press Mute button + Volume DOWN.

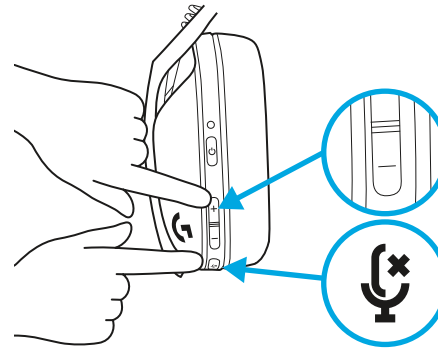

SPARE PARTS

- Earpads
- Wireless USB Receiver
- Charging Cable

RECYCLING

We encourage you to resell or donate working products. Otherwise, batteries, electronic and electrical equipment should not be disposed of with household waste. Wherever possible, they should be segregated and brought to an appropriate collection point to enable recycling and avoid potential impacts on the environment and human health. For more information, contact your local authorities or place of purchase, or visit www.logitech.com/recycling

QUESTIONS?

logitechG.com/support/G435SE

BATTERY REMOVAL

1

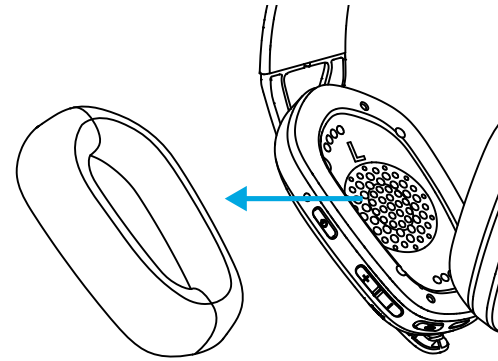

2

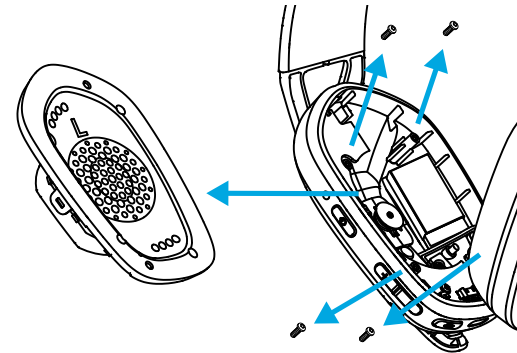

3

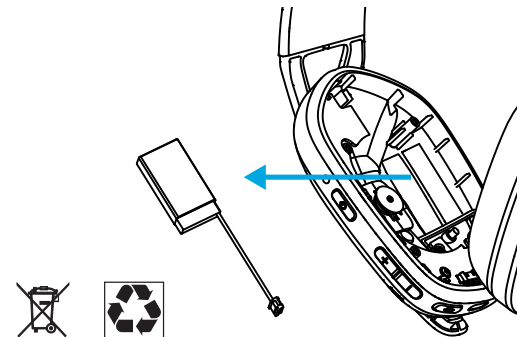

清洁罗技 G435 SE

如果您的罗技 G435 SE 需要清洁, 我们有一些 建议:

清洁之前

- 请勿在洗衣机中清洗耳垫
- 请勿在滚筒烘干机中烘干耳垫
- 不要将清洁液直接倒在耳垫和头带上。
- 请勿使用漂白剂、丙酮/指甲油去除剂、强溶剂或研磨剂, 因为它们可能会影响聚酯织物的表面状况并导致变色。
- 使用清洁喷雾剂时, 请先喷到布上再进行擦拭, 请勿直接喷向产品。

擦拭和清洁您的 G435 SE

- 要擦拭或清洁耳机麦克风, 请使用普通自来水轻轻蘸湿干净、柔软的无绒布, 然后轻轻擦拭头带和耳垫。
- 对于较为严重的污渍, 您还可以在稍微湿润的干净软布上使用少量肥皂, 然后轻轻擦拭污渍区域。使用湿布彻底清洁表面。直至擦除所有肥皂痕迹。
- 也可以使用无香味消毒湿巾、无香味抗菌湿巾。
- 在室温下晾干:

Logitech 鼓励用户按照 世界卫生组织和疾病控制中心制定的指南对产品 进行适当的消毒。

使用 LIGHTSPEED 连接耳机麦克风

通过 LIGHTSPEED 无线技术连接您的 PC、Mac、PlayStation 5 或 4

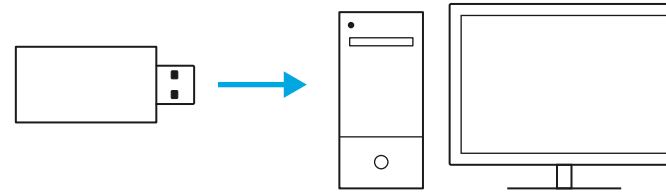

- 将接收器插入设备的 USB 端口。

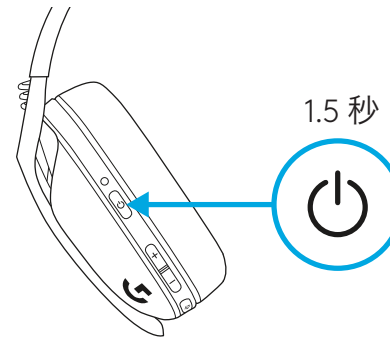

- 按下电源按钮至少 1.5 秒。

- 连接后, LED 想变为青色。

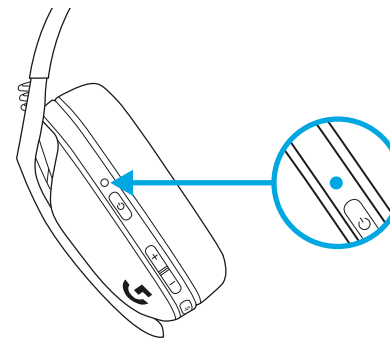

如何使用蓝牙连接您的 G435 SE

- 按住电源+静音按钮至少 3 秒钟。

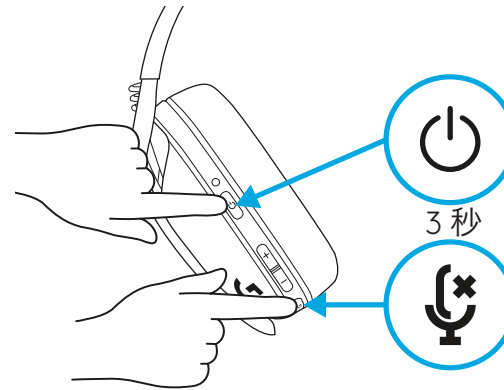

- 进入配对模式后, LED 会闪烁蓝色。

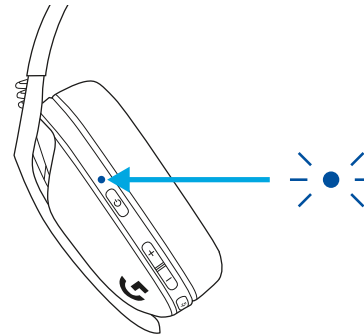

- 在设备的蓝牙列表中查找 G435 SE 并连接。
- 请注意: G435 SE 一次可以连接一个蓝牙设备。

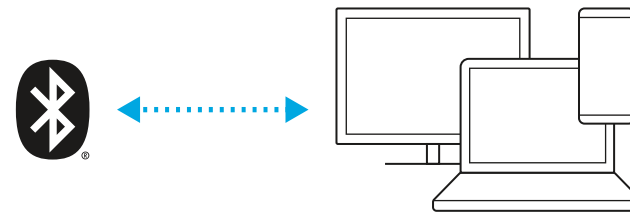

如何在 G435 SE 上切换 LIGHTSPEED 和蓝牙连接模式

- 按住静音按钮至少 3 秒钟。

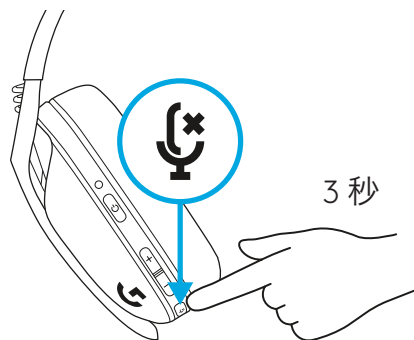

- 切换到 LIGHTSPEED, LED 将亮起青色 5 秒。

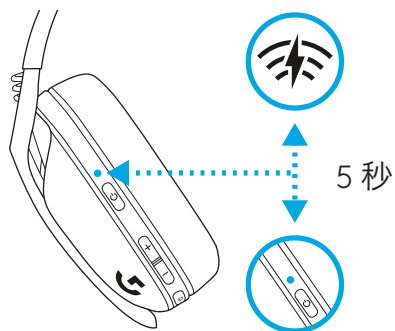

- 切换到蓝牙, LED 会亮起蓝色 5 秒。

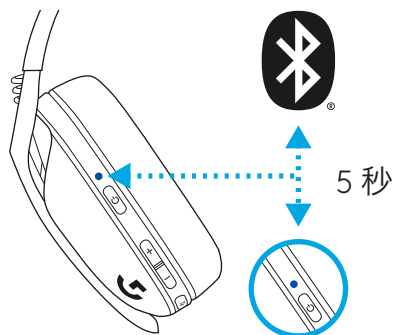

如何打开和关闭 G435 SE

开启电源

- 耳机麦克风关机状态下, 按住电源按钮 约 1.5 秒。

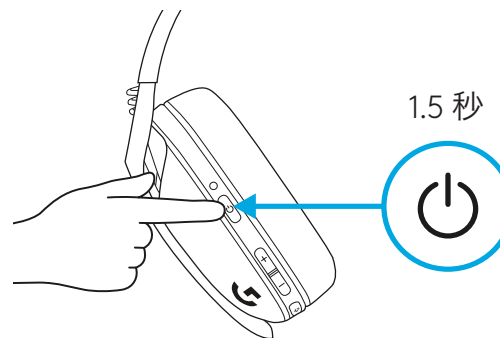

关闭电源

- 耳机麦克风开机状态下, 按住电源按钮 约 3 秒。

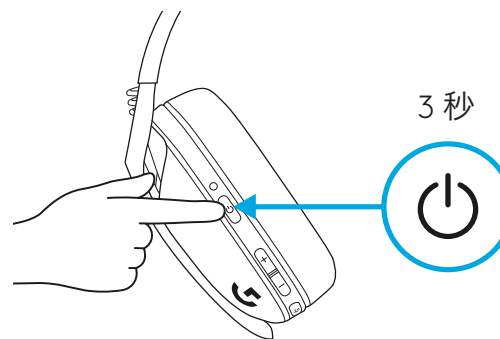

自动关机

- G435 SE 在闲置 约 30 分钟后会自动关机。

如何在 G435 SE 上切换静音/取消静音和最大音量

麦克风静音控制

- 短按静音按钮。

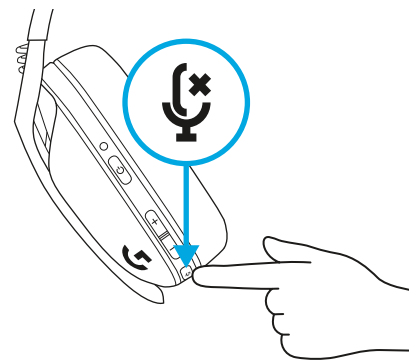

设置最大音量

- 设置为 100 dB
 - 按住静音按钮 + 音量上升至少 3 秒钟。
 - LED 将闪烁橙色 3 次。

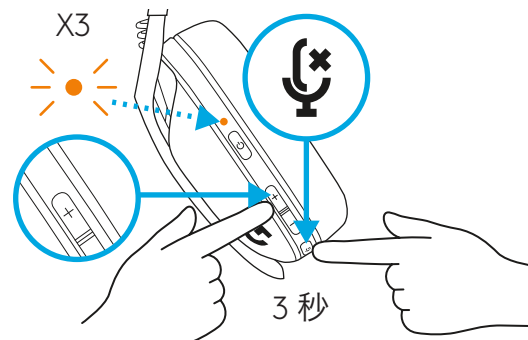

- 设置为 85 dB
 - 按住静音按钮 + 音量下降至少 3 秒钟。
 - LED 将亮起橙色 5 秒。

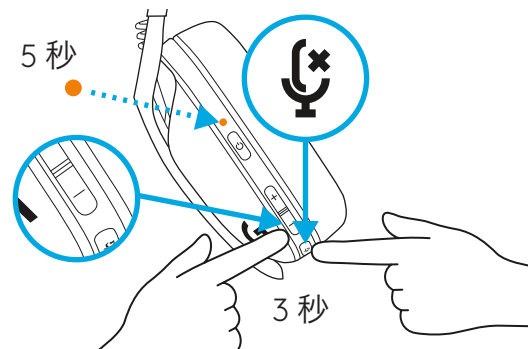

检查 G435 SE 的电池电量

- 耳机麦克风开机状态下, 按一下电源按钮
 - LED 亮起绿色 5 秒, 代表电量在 31% 到 100% 之间。

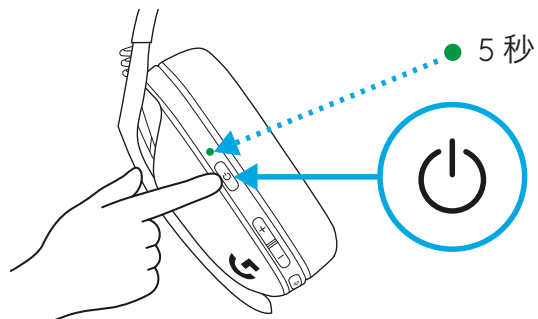

- LED 亮起红色 5 秒, 代表电量在 15% 到 30% 之间。

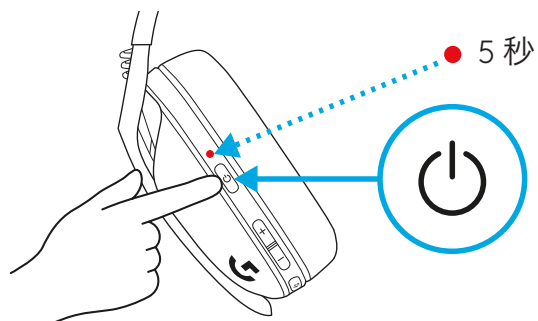

- LED 闪烁红色 5 秒, 代表电量低于 15%。

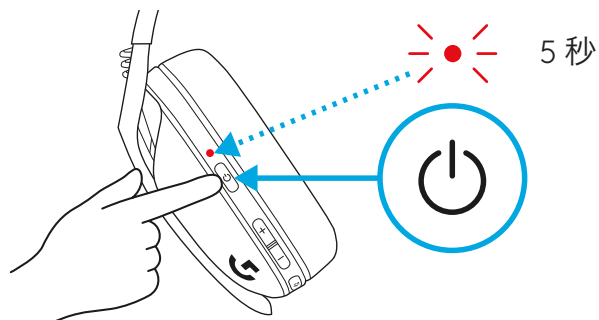

在 G435 SE 上设置侧音

侧音功能让您在与他人交流时可以听到自己的声音。可以实现使用电话进行通话的体验, 并且可以将您的说话声音调节至适当的音量。

- 启用侧音

- 按两次静音按钮, LED 将闪烁**橙色**两次。

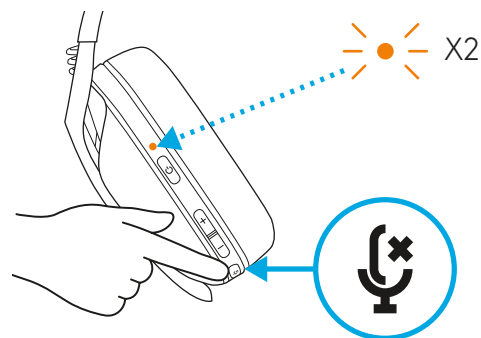

- 禁用侧音

- 按两次静音按钮, LED 将闪烁**橙色**一次。

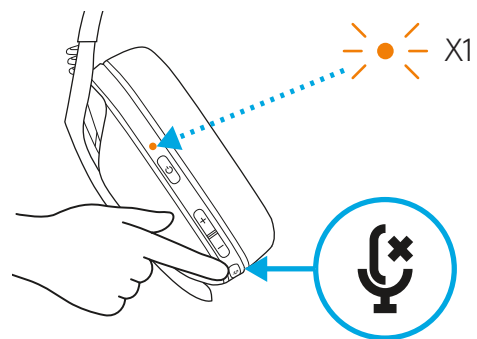

- 调节侧音

- 增加 = 按一下静音按钮 + 音量上升按钮。

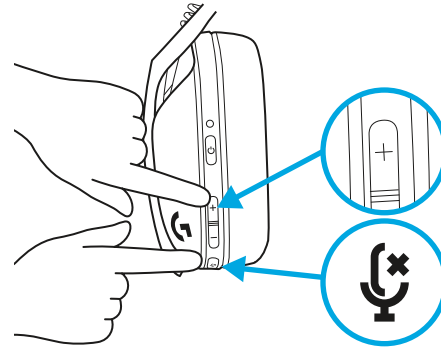

- 减少 = 按一下静音按钮 + 音量下降按钮。

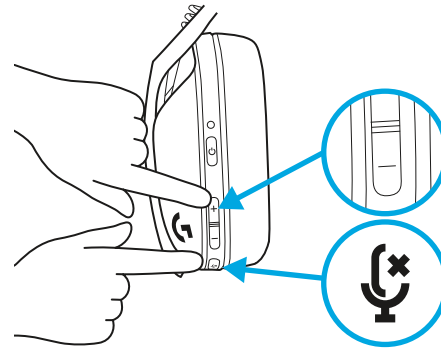

备件

- 耳垫
- 无线 USB 接收器
- 充电线缆

回收

我们鼓励您转售或捐赠仍可运行的产品。若非如此，电池、电子设备和电气设备不应与生活垃圾一同处理。只要情况允许，应将其隔离并带到适当的收集点，以便回收利用，并避免对环境和人类健康的潜在影响。欲了解更多信息，请联系当地主管部门或购买地点，或访问 www.logitech.com/recycling

遇到问题？

logitechG.com/support/G435SE

电池移除

1

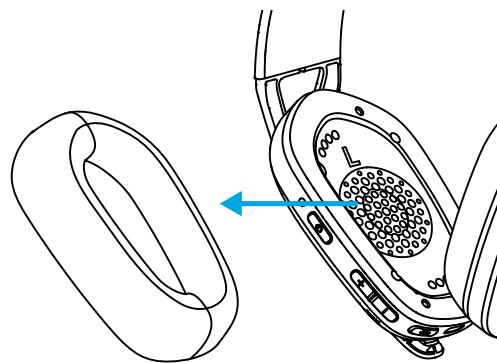

2

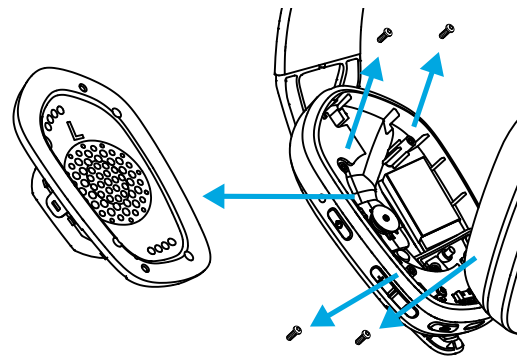

3

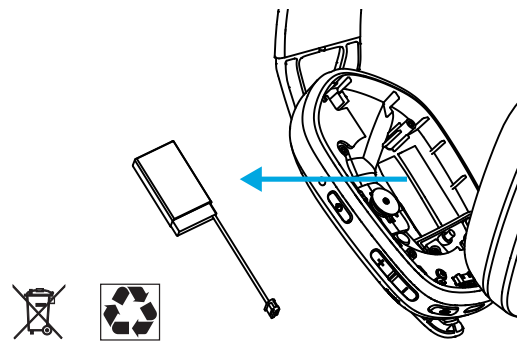

清潔羅技 G435 SE

如果需要清潔您的羅技 G435 SE，這裡提供一些 建議。

清潔之前

- 不要使用洗衣機清潔耳墊
- 不要使用吹風機吹乾耳墊。
- 不要在耳墊和頭帶上直接倒上清潔液。
- 切勿使用漂白劑、丙酮/指甲油去除劑、強力溶劑或研磨劑，因為這些可能會影響聚酯布料表面狀況並導致變色。
- 使用清潔劑噴灑器時，請噴灑到布料上將其沾濕，不要直接噴灑到產品上。

擦拭和清潔 G435 SE

- 若要擦拭或清潔耳機麥克風，請將乾淨、柔軟無布絮的布料用自來水稍稍沾濕，然後輕輕擦拭頭帶和耳墊。
- 對於較嚴重的污漬，您也可以在稍微濕潤的乾淨軟布上抹上少量肥皂，然後輕輕擦拭污漬區域。使用相同的濕布徹底沖洗表面。重複進行直到所有的肥皂痕跡消失。
- 也可以使用無香味消毒濕巾、無香味抗菌濕巾。
- 在室溫下將其晾乾。

羅技鼓勵使用者依照世界衛生組織與疾病控制中心的指南，對產品進行適當的消毒。

使用 LIGHTSPEED 連線耳機麥克風

利用 LIGHTSPEED 無線技術，連線到您的 PC、Mac、PlayStation 5 或 4。

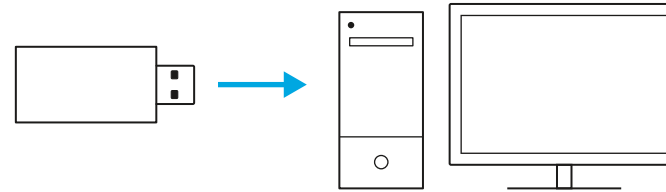

- 將接收器插入到您裝置的 USB 連接埠。

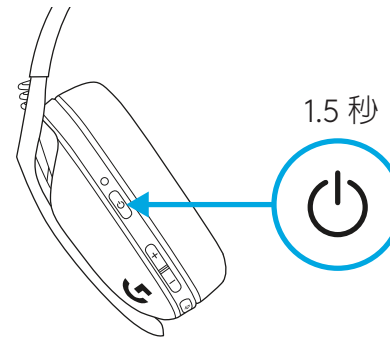

- 按住電源按鈕至少 1.5 秒鐘。

- 連線後，LED 指示燈會亮起青燈。

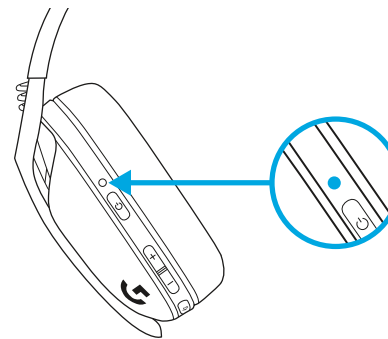

使用藍牙連線 G435 SE

- 按住電源按鈕 + 靜音按鈕 3 秒或更久時間。

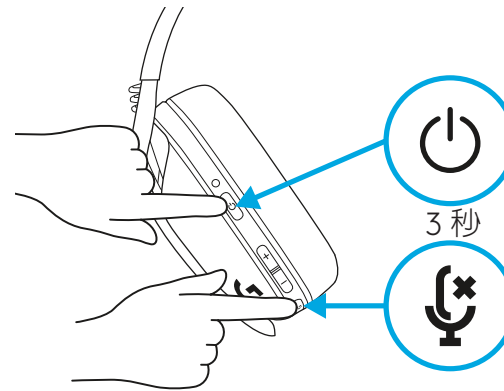

- 當裝置進入配對模式時，LED 指示燈會閃爍藍燈。

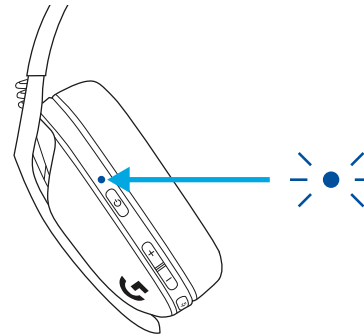

- 在您裝置的藍牙清單中尋找 G435 SE，然後連線。
- 注意：G435 SE 一次可以連線到一個藍牙裝置。

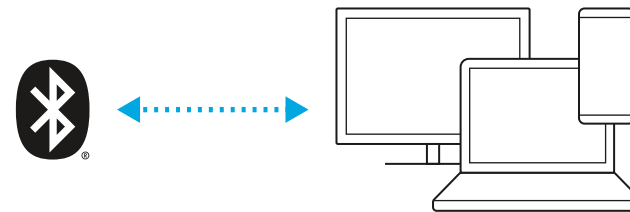

在 G435 SE 上切換使用 LIGHTSPEED 和藍牙 連線模式

- 按住靜音按鈕 3 秒或更久時間。

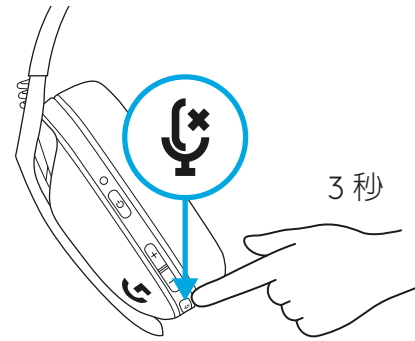

- 切換到 LIGHTSPEED，LED 指示燈會亮起青燈 5 秒。

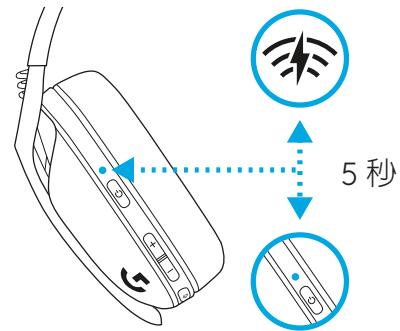

- 切換到藍牙，LED 指示燈會亮起藍燈 5 秒。

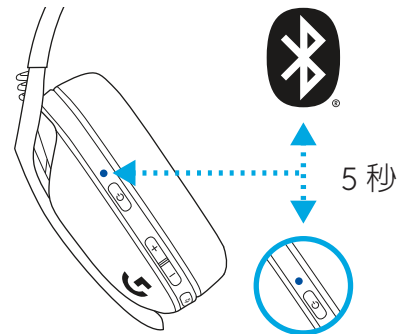

開啓與關閉 G435 SE 電源

開啓電源

- 在耳機麥克風電源關閉時，按下電源按鈕 1.5 秒。

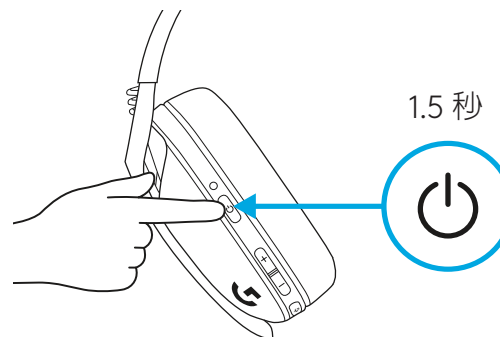

關閉電源

- 在耳機麥克風電源開啓時，按下電源按鈕 3 秒。

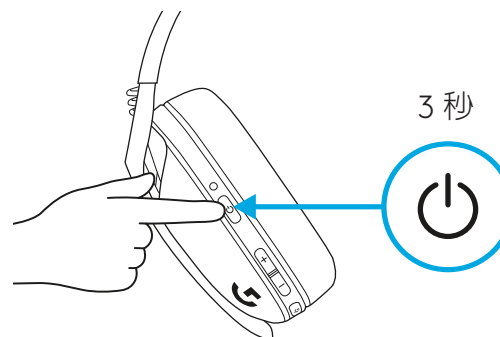

自動關機

- G435 SE 會在 30 分鐘沒有動作後自動關閉電源。

在 G435 SE 上切換靜音 / 取消靜音與最大音量

靜音/取消靜音麥克風

- 短按靜音按鈕

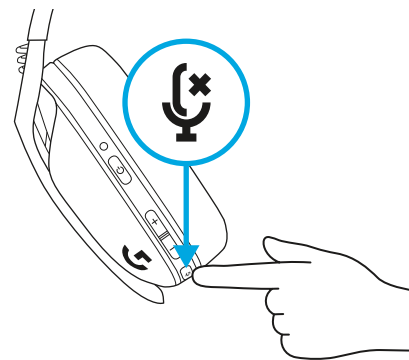

設定最大音量

- 設定 100 dB
 - 按住靜音按鈕 + 音量增加按鈕 3 秒或更久時間。
 - LED 指示燈會閃爍**橙燈** 3 次。

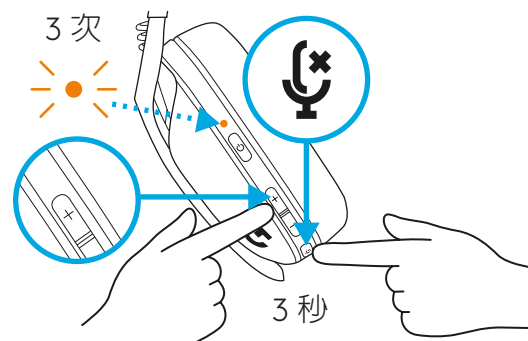

- 設定 85 dB
 - 按住靜音按鈕 + 音量減少按鈕 3 秒或更久時間。
 - LED 指示燈會亮起穩定**橙燈** 5 秒。

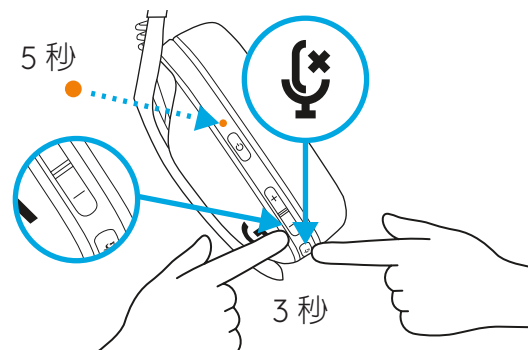

查看 G435 SE 的電池電量

- 當耳機麥克風電源開啓時，按一下電源按鈕
 - LED 指示燈會亮起綠燈 5 秒，表示其電池電量介於 31% 到 100% 之間。

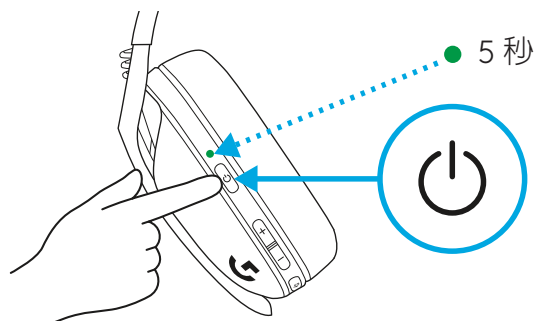

- LED 指示燈會亮起紅燈 5 秒，表示其電池電量介於 15% 到 30% 之間。

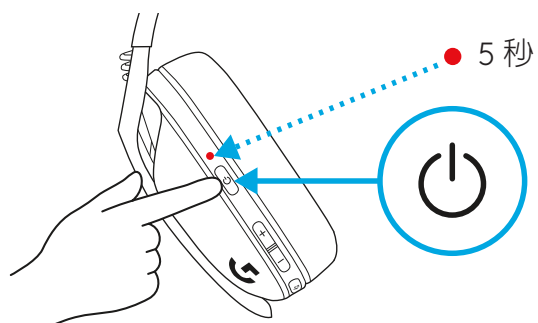

- LED 指示燈會閃爍紅燈 5 秒，表示其電池電量 <15%。

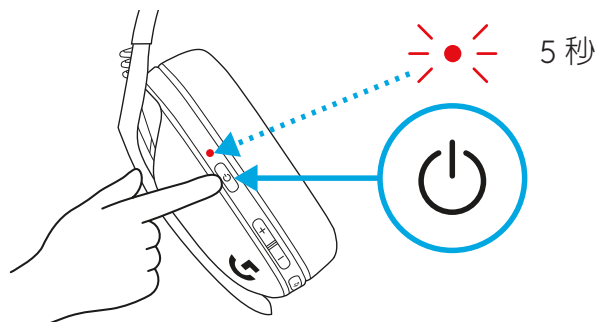

在 G435 SE 上設定側音

側音讓您可以在與其他人通訊時聽到自己的聲音。其可反映通話體驗，讓您可將說話音量調整到適當音量。

- 啟用側音

- 按兩下靜音按鈕，LED 指示燈會閃爍**橙燈**兩次。

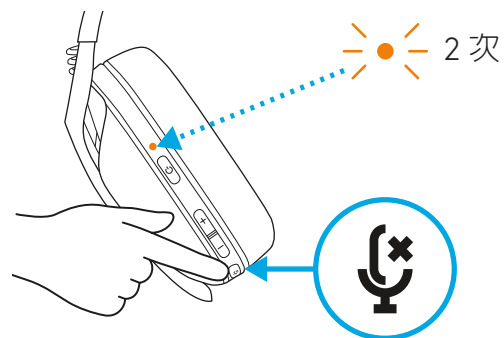

- 停用側音

- 按兩下靜音按鈕，LED 指示燈會閃爍**橙燈**一次。

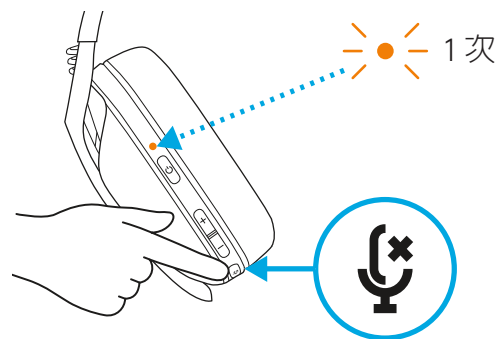

- 調整側音

- 增加 = 按一下靜音按鈕 + 音量增加。

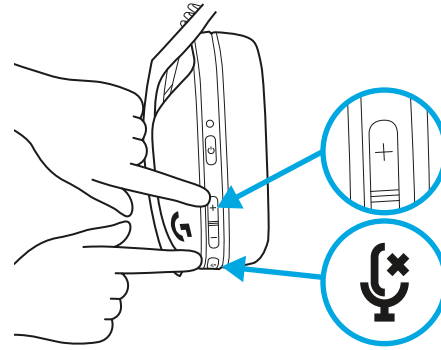

- 減少 = 按一下靜音按鈕 + 音量減少。

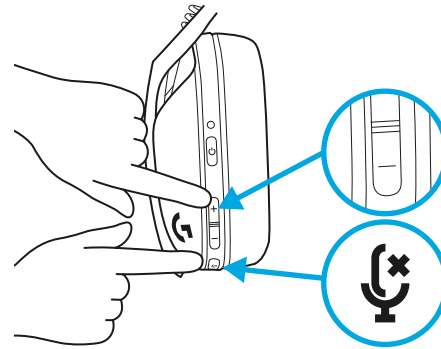

備用零件

- 耳墊
- 無線 USB 接收器
- 充電連接線

回收

我們鼓勵您轉售或捐贈可用的產品。否則，電池與電子廢棄物不應隨家庭廢棄物棄置。在可能時，應將其區分開並帶到適當的收集點以進行回收，避免可能對環境和人體健康造成潛在影響。如需詳細資訊，請聯繫您當地的機關或購買場所，或是造訪 www.logitech.com/recycling

有問題？

logitechG.com/support/G435SE

卸除電池

1

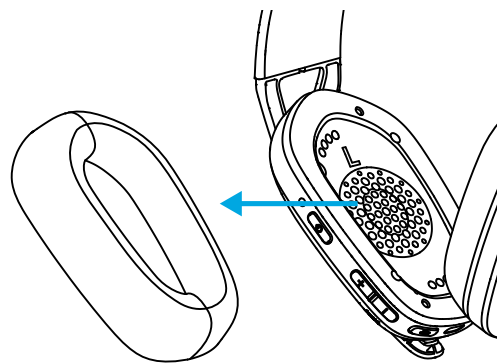

2

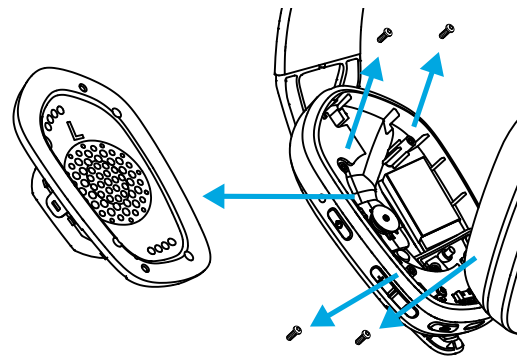

3

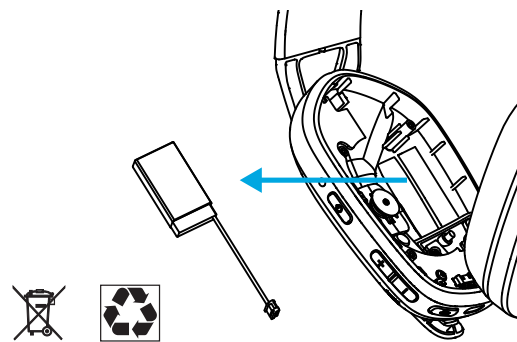

로지텍 G435 SE 세척

로지텍 G435 SE를 세척해야 하는 경우, 추천하는 방법은 다음과 같습니다.

세척 전 주의 사항

- 세탁기를 사용하여 이어패드를 세척하지 마세요.
- 회전식 건조기에서 이어패드를 건조하지 마세요.
- 이어패드와 헤드밴드에 세정액을 바로 묻히면 안 됩니다.
- 표백제, 아세톤/네일 리무버, 강력한 용제, 연마제를 사용하지 마세요. 폴리에스터 표면에 영향을 미치거나 변색시킬 수 있습니다.
- 세정 스프레이를 사용하는 경우, 천에 스프레이를 뿌린 뒤 닦아내세요. 제품에 스프레이를 곧바로 뿌리지 마세요.

G435 SE 닦기 및 세척

- 헤드셋을 닦거나 세척하려면 보풀이 없는 깨끗하고 부드러운 천에 수돗물을 약간 적셔 헤드밴드와 이어패드를 부드럽게 닦아냅니다.
- 강력한 얼룩이 있는 경우, 살짝 적신 깨끗하고 부드러운 천에 약간의 비누를 이용하여 얼룩 부분을 부드럽게 닦아냅니다. 같은 적신 천을 사용하여 표면을 완전히 씻어냅니다. 비누를 사용한 흔적이 완전히 사라질 때까지 반복합니다.
- 무향 살균 티슈나 무향 향균 물티슈를 사용해도 됩니다.
- 실온에서 건조하십시오.

로지텍은 사용자가 세계 보건 기구의 지침과 질병 통제 센터 지침에 따라 적절하게 제품을 소독하는 것을 권장합니다.

LIGHTSPEED로 헤드셋 연결

LIGHTSPEED 무선 기술로 PC, Mac, PlayStation 5 또는 4에 연결.

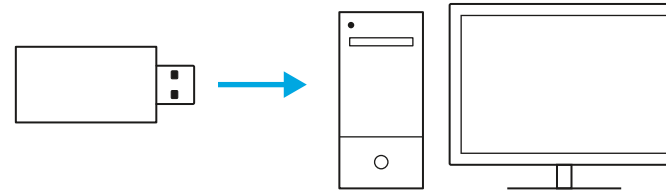

- 장치의 USB 포트에 수신기를 삽입합니다.

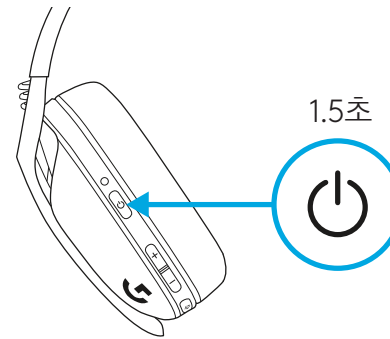

- 전원 버튼을 1.5초 이상 누릅니다.

- 연결되면 LED가 **청록색**으로 바뀝니다.

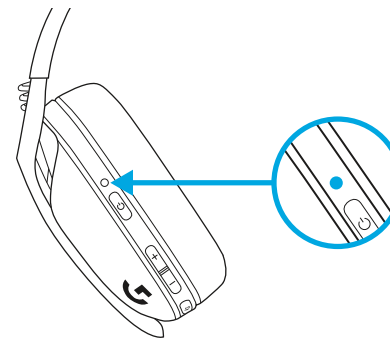

BLUETOOTH로 G435 SE를 연결하는 방법

- 전원 + 음소거 버튼을 3초 이상 누릅니다.

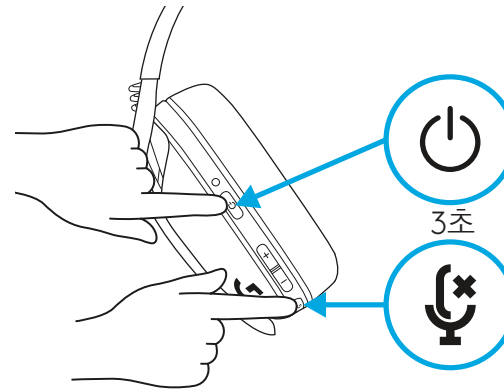

- 페어링 모드에 진입하면 LED가 파란색으로 깜박입니다.

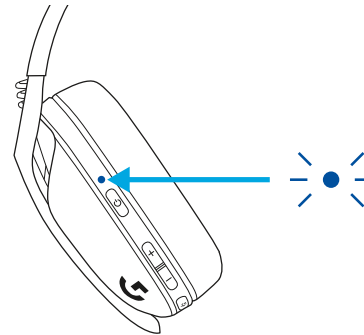

- 장치의 Bluetooth 목록에서 G435 SE를 찾아 연결합니다.
- 참고: G435 SE는 한 번에 하나의 Bluetooth 장치에 연결할 수 있습니다.

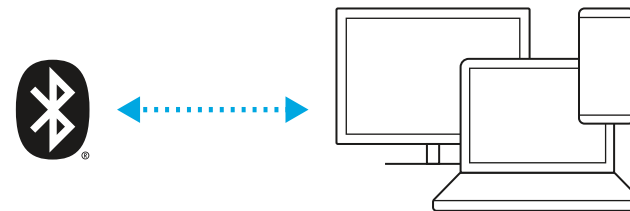

G435 SE에서 LIGHTSPEED 및 BLUETOOTH 연결 모드를 전환하는 방법

- 음소거 버튼을 3초 이상 누릅니다.

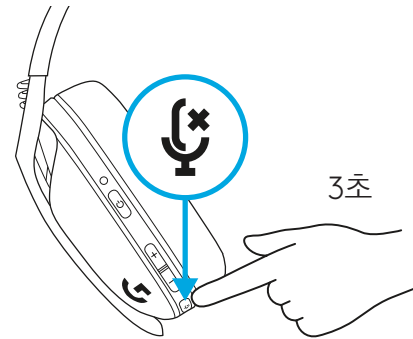

- LIGHTSPEED로 전환하면, 5초 동안 **청록색** LED가 켜집니다.

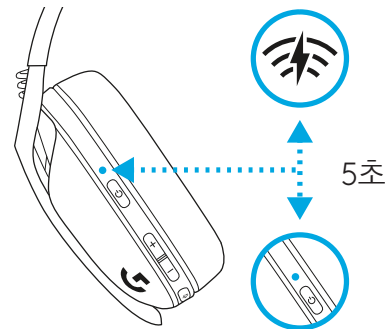

- Bluetooth로 전환하면, 5초 동안 **파란색** LED가 켜집니다.

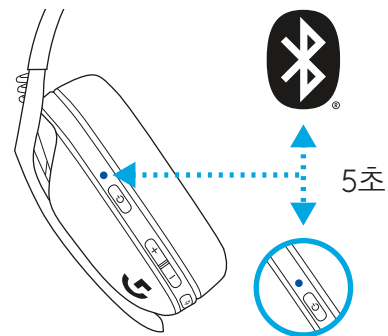

G435 SE의 전원을 켜고 끄는 방법

전원 켜기

- 헤드셋이 꺼져 있을 때 전원 버튼을 1.5초 동안 누릅니다.

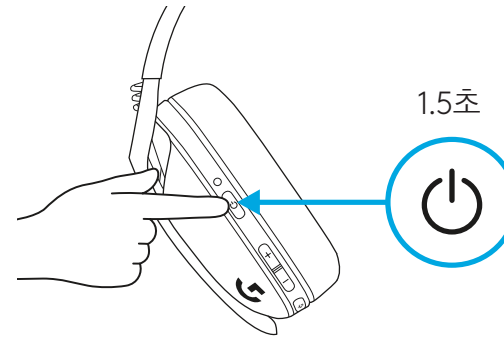

전원 끄기

- 헤드셋이 켜져 있을 때 전원 버튼을 3초 동안 누릅니다.

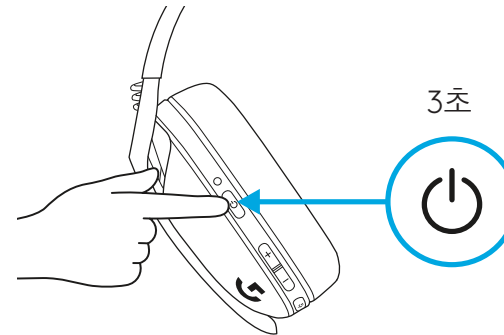

전원 종료

- G435 SE는 활동이 없으면 30분 뒤에 자동으로 꺼집니다.

G435 SE에서 음소거/음소거 해제 및 최대 볼륨을 토글하는 방법

마이크 음소거 / 음소거 해제

- 음소거 버튼을 짧게 누릅니다.

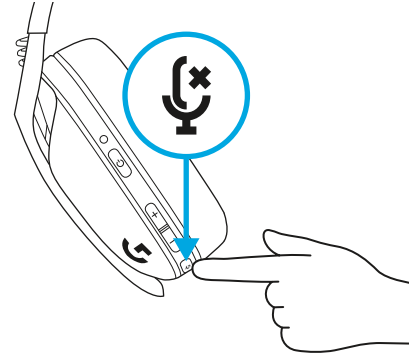

최대 볼륨 설정

- 100 dB로 설정
 - 음소거 버튼 + 볼륨 높이기 버튼을 3초 이상 누릅니다.
 - LED가 3번 주황색으로 깜박입니다.

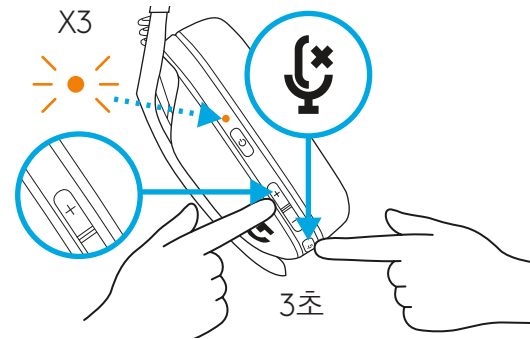

- 85 dB로 설정

- 음소거 버튼 + 볼륨 낮추기 버튼을 3초 이상 누릅니다.
- LED가 5초 동안 주황색으로 켜집니다.

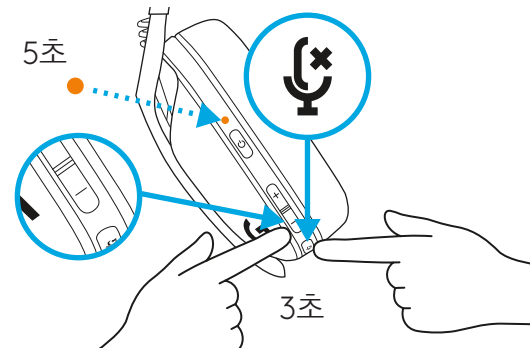

G435 SE의 배터리 레벨 확인하기

- 헤드셋이 켜져 있을 때, 전원 버튼을 한 번 누릅니다.
- LED가 5초 동안 초록색으로 표시되면 남은 배터리가 31~100% 사이라는 뜻입니다.

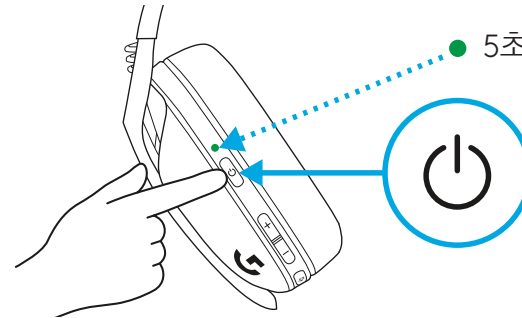

- LED가 5초 동안 빨간색으로 표시되면 남은 배터리가 15~30% 사이라는 뜻입니다.

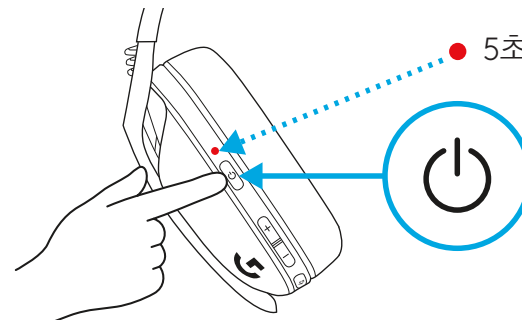

- LED가 5초 동안 빨간색으로 깜박이면 남은 배터리가 15% 미만이라는 뜻입니다.

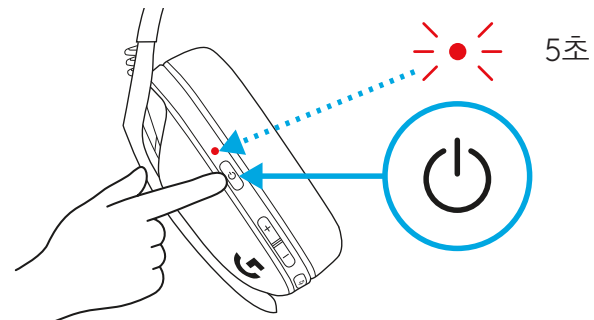

G435 SE의 사이드톤 설정하기

사이드톤은 다른 사람과 소통 시 내 목소리를 들려주는 기능입니다. 전화 통화 경험을 미러링하여 적절한 수준으로 목소리를 조절할 수 있게 해줍니다.

- 사이드톤 활성화

- 음소거 버튼을 두 번 누르면 LED가 주황색으로 두 번 깜박입니다.

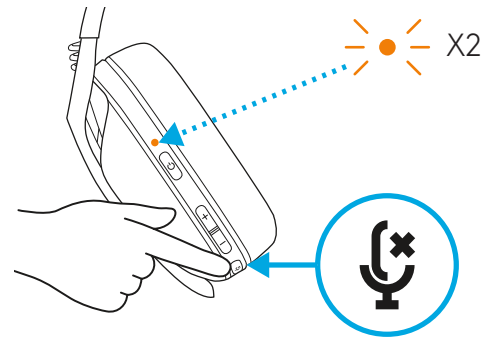

- 사이드톤 비활성화

- 음소거 버튼을 두 번 누르면 LED가 주황색으로 한 번 깜박입니다.

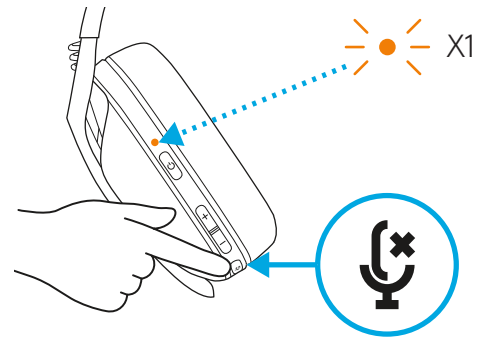

- 사이드톤 조절

- 높임 = 음소거 버튼 + 볼륨 높이기 버튼을 한 번 누릅니다.

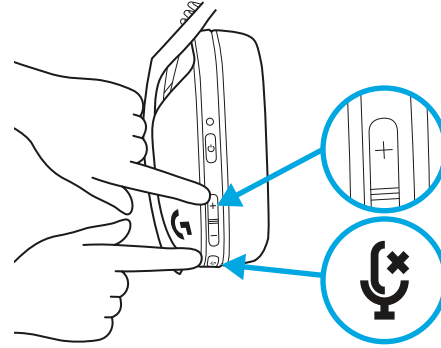

- 낮춤 = 음소거 버튼 + 볼륨 낮추기 버튼을 한 번 누릅니다.

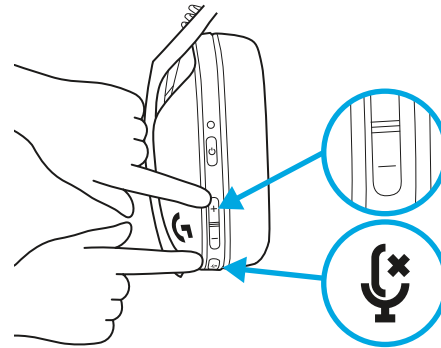

예비 부품

- 이어 패드
- 무선 USB 수신기
- 충전 케이블

재활용

작동하는 제품인 경우 재판매 또는 기부를 권장합니다. 재판매나 기부를 하지 않는 경우, 배터리, 전자기기, 전기장비는 생활 폐기물과 함께 처리하면 안 됩니다. 가능하면 재활용과 환경 보호, 공중 보건을 위해 분리하여 정해진 수거 장소에 버려야 합니다. 자세한 사항은 지방 관헌이나 구매처에 문의하십시오. www.logitech.com/recycling에서도 확인할 수 있습니다.

질문이 있으십니까?

logitechG.com/support/G435SE

배터리 제거

1

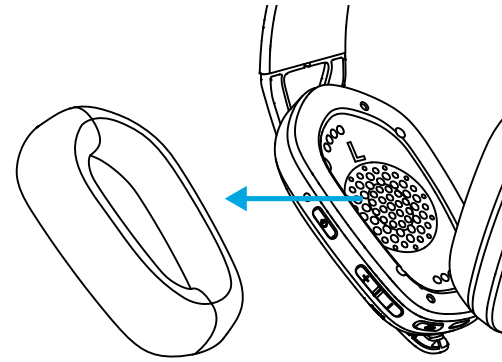

2

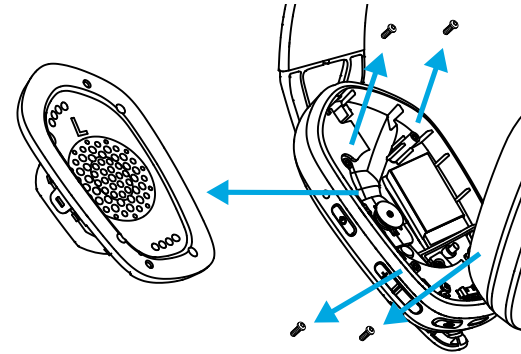

3

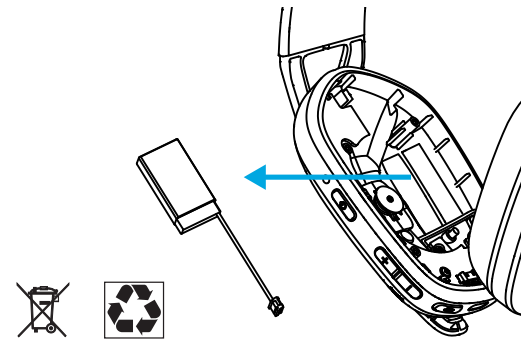



© 2022 Logitech. Logitech, Logitech G and the Logitech and Logitech G logos are trademarks or registered trademarks of Logitech Europe S.A. and/or its affiliates in the U.S. and other countries. All other trademarks are the property of their respective owners. Logitech assumes no responsibility for any errors that may appear in this manual. Information contained herein is subject to change without notice.

版权所有 © 2022 罗技。罗技、Logi、Logitech 和罗技标志为罗技欧洲公司和/或其美国及其他国家/地区附属公司的商标，并或已注册。罗技对于本手册中可能出现的任何错误不承担任何责任。本手册中包含的信息如有更改，恕不事先通知。

WEB-621-002177 002