

G715 KEYBOARD | G715 键盘

Wireless Gaming Keyboard
无线游戏键盘

SETUP GUIDE | 设置指南





ENGLISH 3

简体中文 10

繁體中文 17

한국어 24

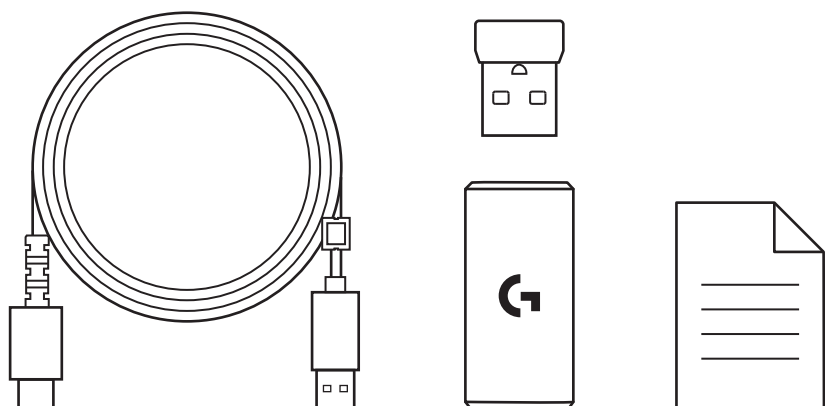
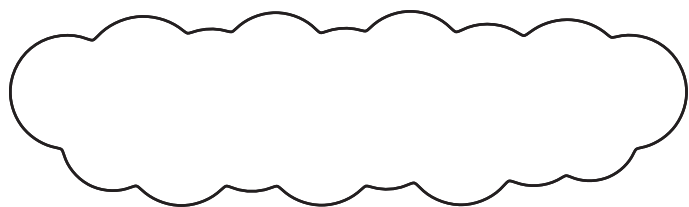
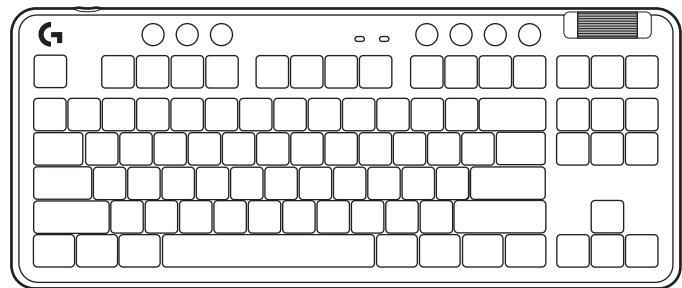

SETUP INSTRUCTIONS

1 Remove the LIGHTSPEED receiver from the storage slot.

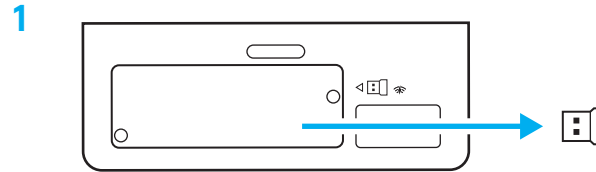

2 Insert the LIGHTSPEED receiver, with extender and cable into the PC USB port. Receiver can be used without the extender and cable by inserting it directly into a USB port if desired.

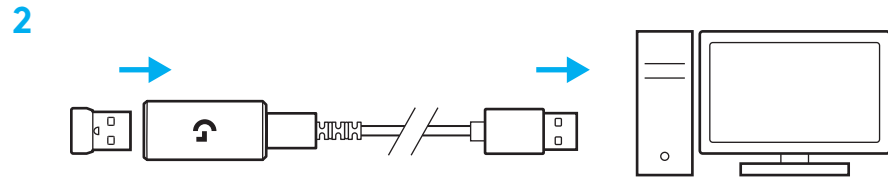

3 Turn on the keyboard by sliding the power button.
The Connection button will light up to a cyan color.

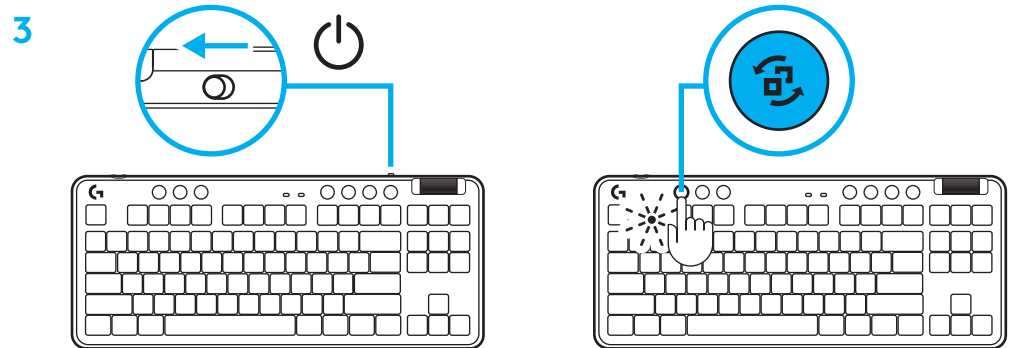

4 Download and install G HUB software to your PC/MAC for the best gaming experience (G HUB has onboarding story for features).
Go to www.logitechG.com/ghub



BLUETOOTH® CONNECTIVITY

1 Turn on the keyboard by sliding the button.

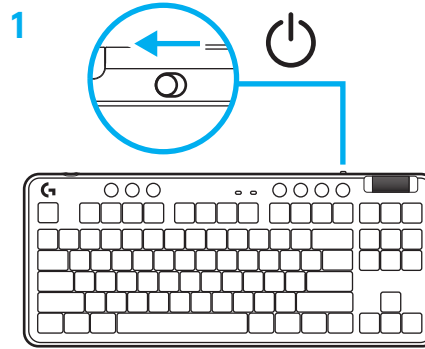

2 Press Connection button to cycle to *Bluetooth*®. Light will turn to light blue and flash quickly - waiting to pair.

Follow *Bluetooth*® connection for your device to pair with the keyboard.

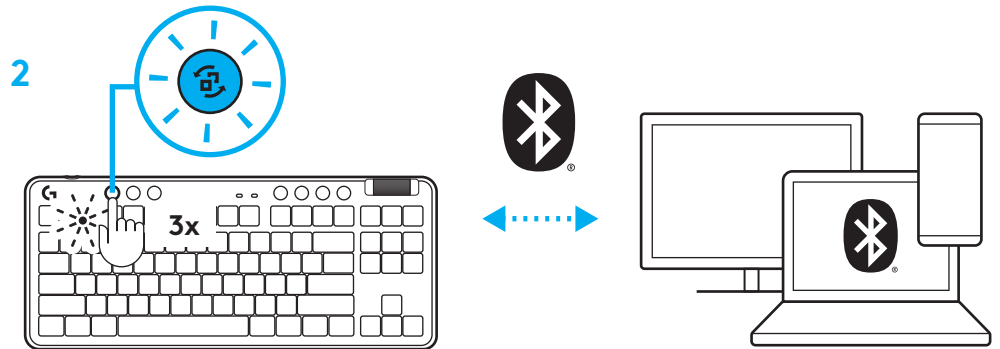

CHARGING YOUR KEYBOARD

- 1 Insert the USB-C cable into the port at the front of the keyboard.
- 2 Connect the cable to your PC.

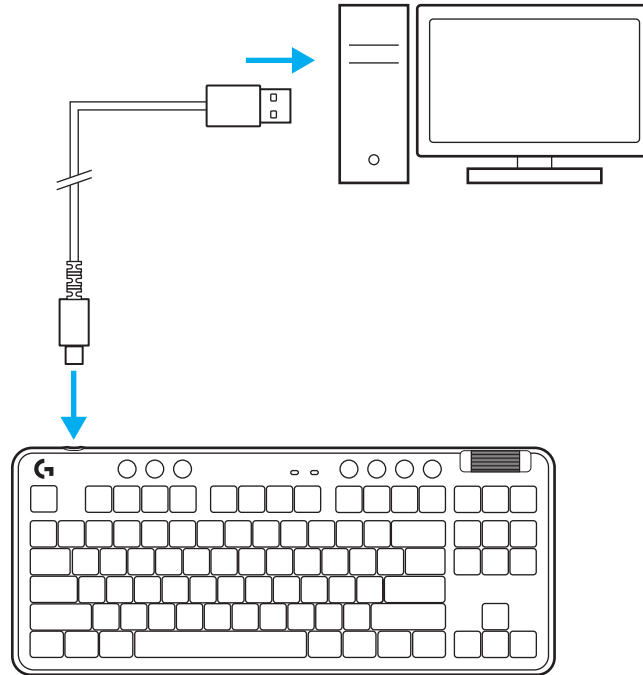

Battery indicator light will pulse green while charging and be solid green when fully charged.

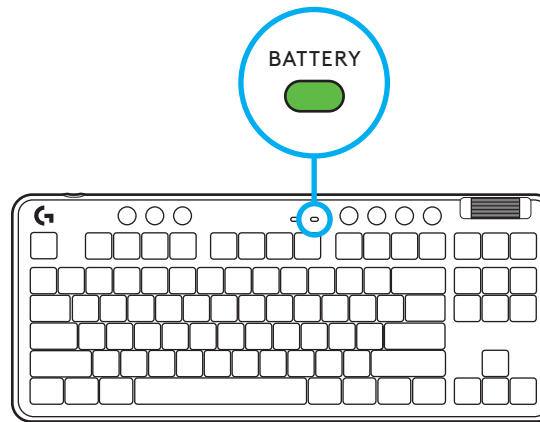

Media Controls

G715 includes media controls. Skip back, play/pause, skip forward and mute key, with a volume roller that controls your device volume.

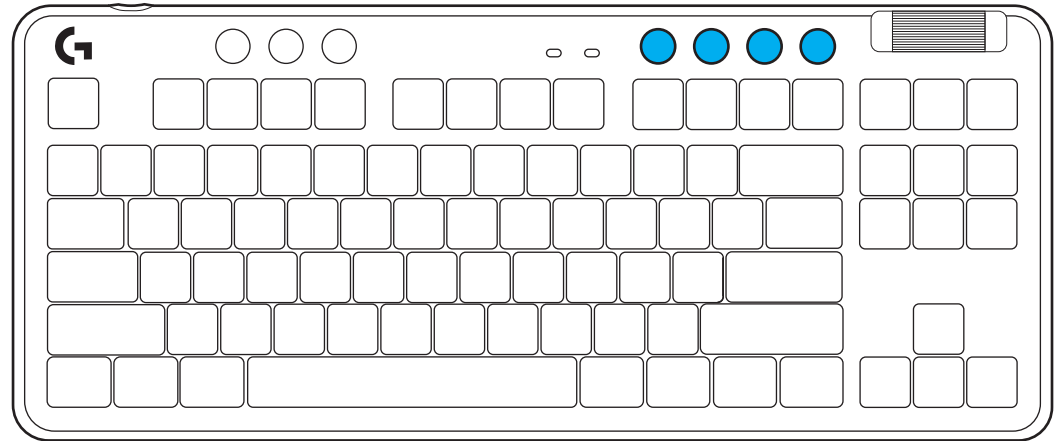

Game Mode

Pressing the Game mode button blocks the Windows and Menu keys when pressed. Additional keys can be blocked using G HUB software.

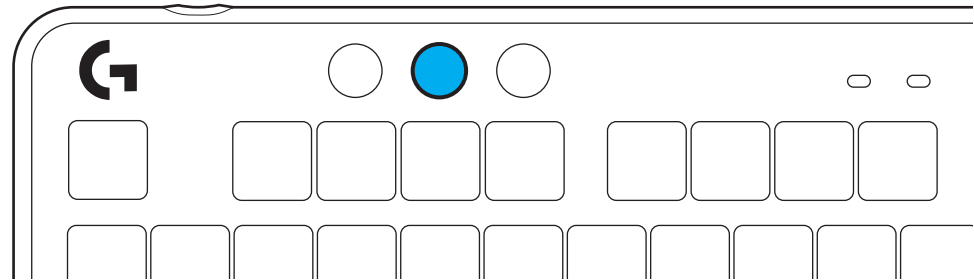

Brightness

Adjust lighting brightness by pressing the brightness button.

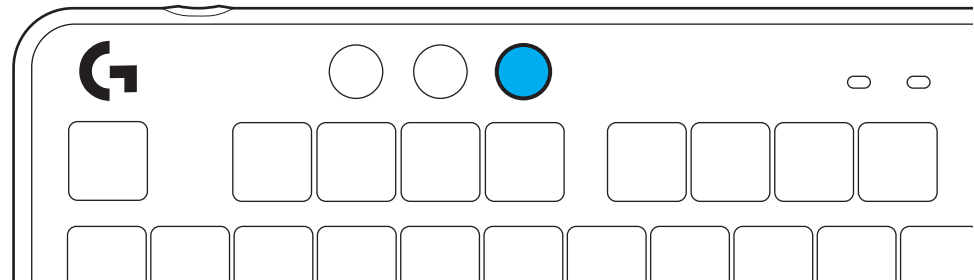

ONBOARD LIGHTING EFFECTS

The keyboard has 8 different lighting effects stored in its onboard memory. You can select and modify these by pressing the Brightness button and these keys:

Brightness + 1 = Rainbow > right

Brightness + 2 = Rainbow > left

Brightness + 3 = Rainbow center out

Brightness + 4 = Rainbow ^ up

Brightness + 5 = Color cycle

Brightness + 6 = Keystroke ripple

Brightness + 7 = Breathing cyan

Brightness + 8 = Custom lighting effect

Brightness + 9 = Custom lighting effect

Brightness + 0 = Solid cyan

Brightness + - = Animation slower

Brightness + = = Animation faster

G HUB lighting controls will override these settings.

CHANGING THE TOP PLATE

The top plate can be removed and replaced with optional accessory top plates.

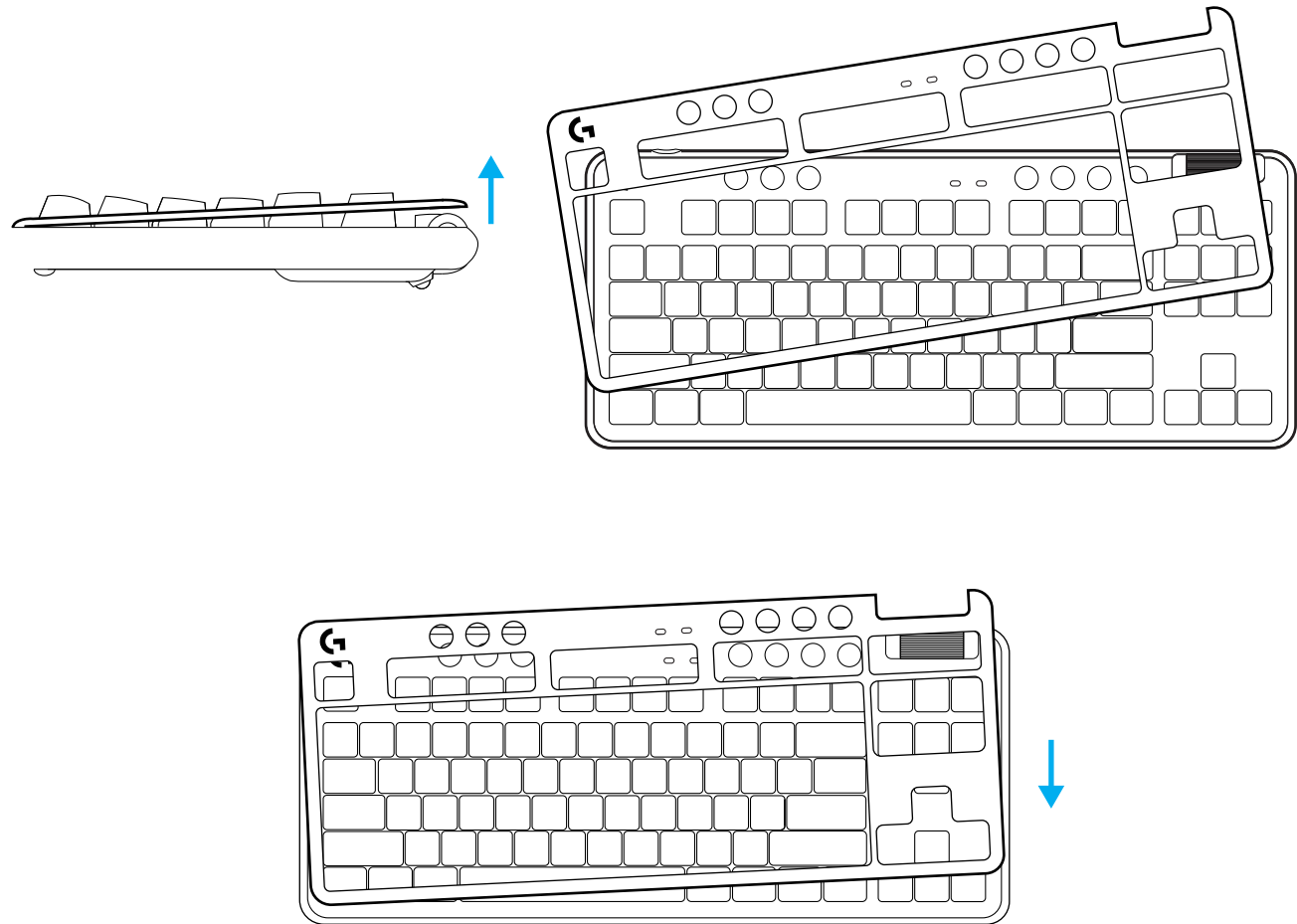

SWITCH BETWEEN LIGHTSPEED WIRELESS AND *BLUETOOTH*[®] DEVICES

Once connected, press the connect button to toggle connection. It will be a light cyan color for LIGHTSPEED, and a blue color for *Bluetooth*[®].

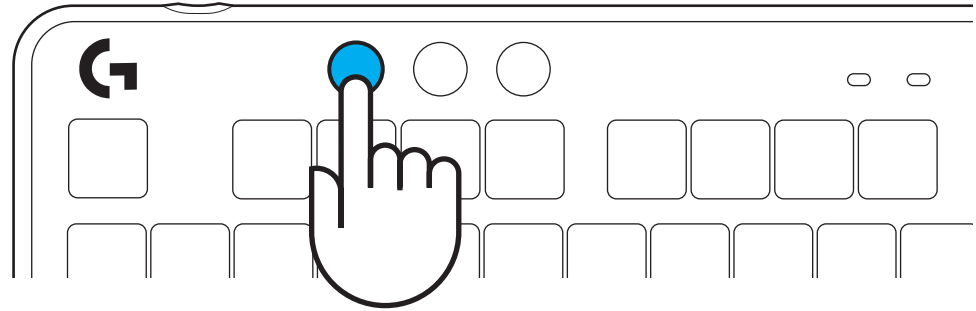

设置说明

1 从收纳槽中取出 LIGHTSPEED 接收器。

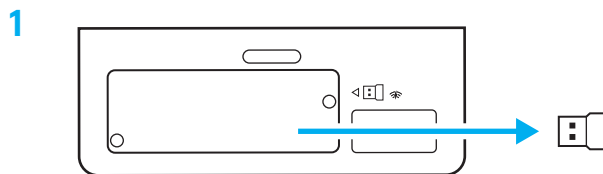

2 将 LIGHTSPEED 接收器插入扩展器和延长线，并插入 PC USB 端口。可以根据需要直接将接收器插入 USB 端口，无需扩展器和延长线即可使用。

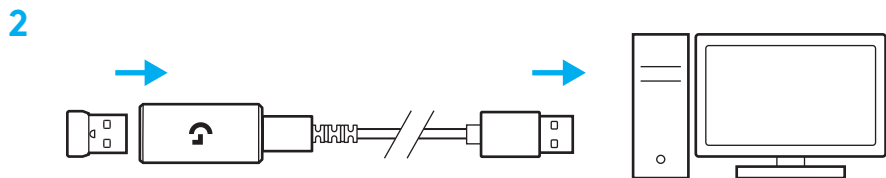

3 拨动电源按钮，打开键盘。

连接按钮将亮起青色。

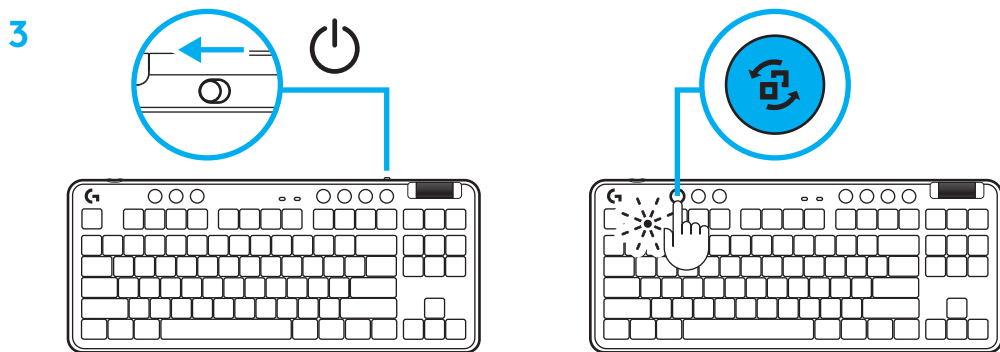

4 下载 G HUB 软件并安装到 PC/MAC，获得更出色的游戏体验（G HUB 包含有关各项功能的入门介绍）。访问 www.logitechG.com/ghub



蓝牙™ 连接

1 拨动按钮，打开键盘。

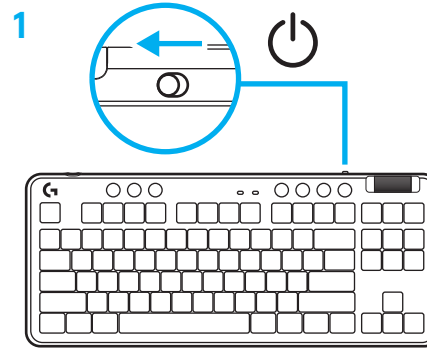

2 按下连接按钮切换为蓝牙™。指示灯将变为浅蓝色并快速闪烁 - 等待配对。

通过蓝牙™ 连接将设备与键盘配对。

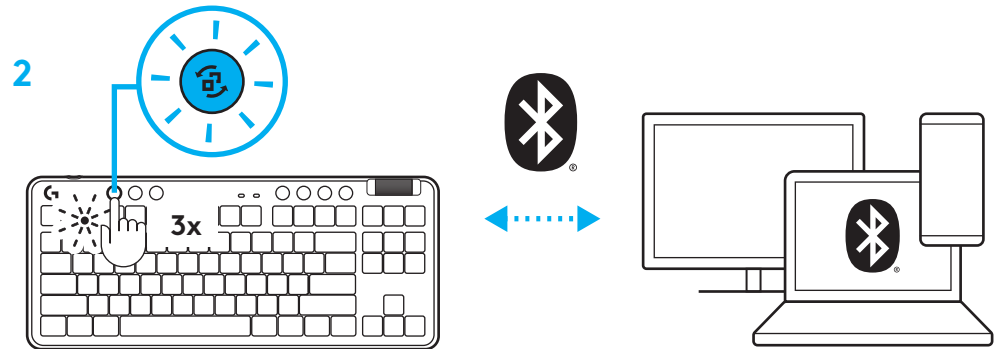

为键盘充电

- 1 将 USB-C 线缆插入键盘正面的端口。
- 2 将线缆连接至 PC。

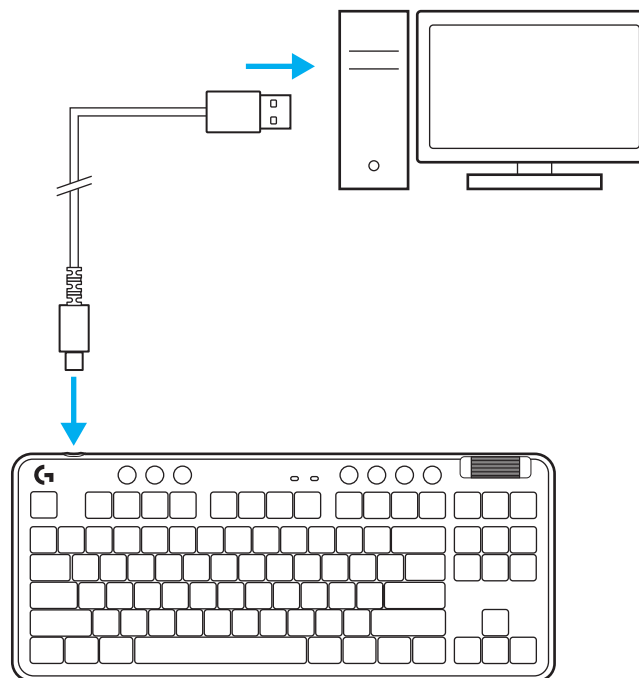

电量指示灯在充电时闪烁绿色，充满电后常亮绿色。

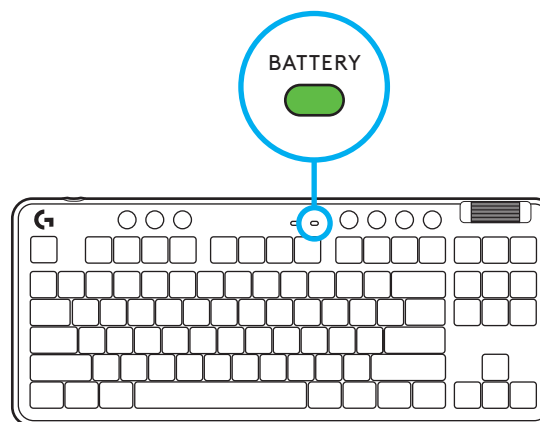

媒体控制

G715 包含媒体控制。上一曲、播放/暂停、下一曲和静音键，使用音量滚轮控制您的设备音量。

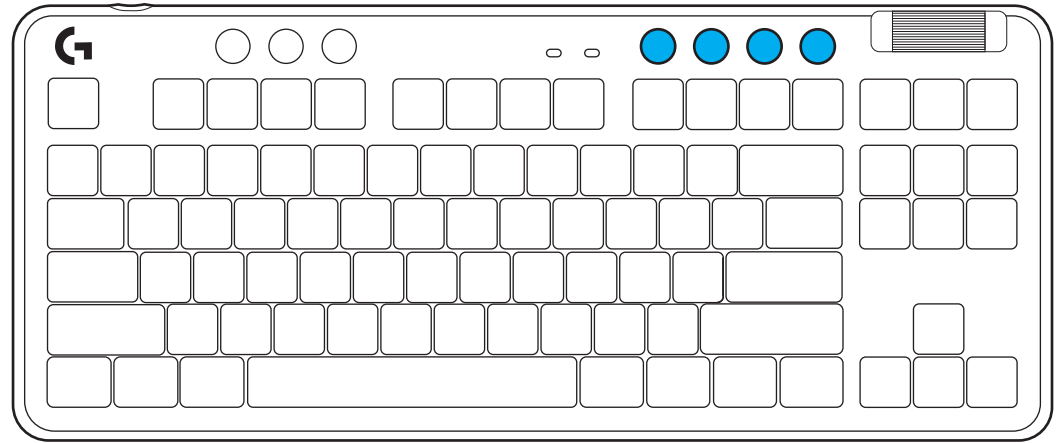

游戏模式

按下游戏模式按钮后会阻止 Windows 和菜单键功能。可以使用 G HUB 软件阻止其他按键。

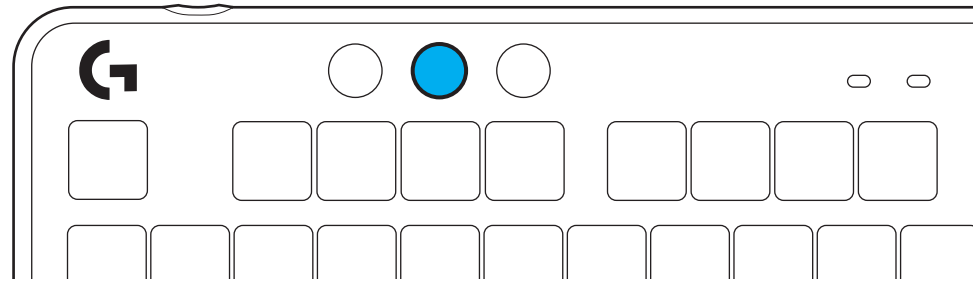

亮度

按下亮度按钮调节灯光亮度。

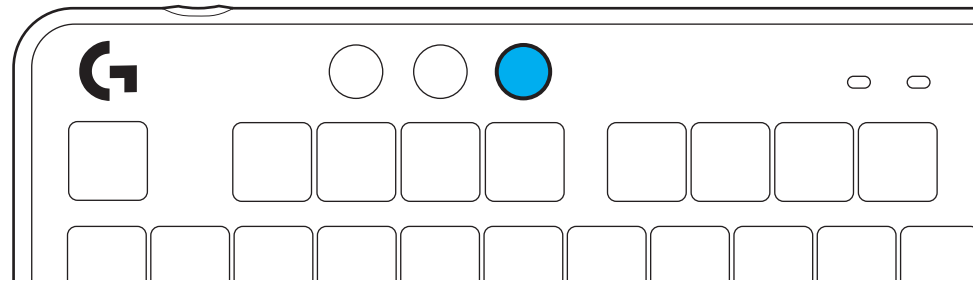

板载灯光效果

键盘在其板载内存中存储了 8 种不同的灯光效果。您可以按下亮度按钮和以下按键来选择和改变灯光效果：

亮度 + 1 = 彩虹 > 右

亮度 + 2 = 彩虹 > 左

亮度 + 3 = 彩虹从中心向外扩散

亮度 + 4 = 彩虹 ^ 上

亮度 + 5 = 色彩循环

亮度 + 6 = 击键波纹

亮度 + 7 = 青色呼吸灯

亮度 + 8 = 自定义灯光效果

亮度 + 9 = 自定义灯光效果

亮度 + 0 = 常亮青色

亮度 + - = 动画效果减速

亮度 + + = 动画效果加速

G HUB 灯光控制将覆盖这些设置。

更换面板

面板可以拆卸并以选配附件面板替换。

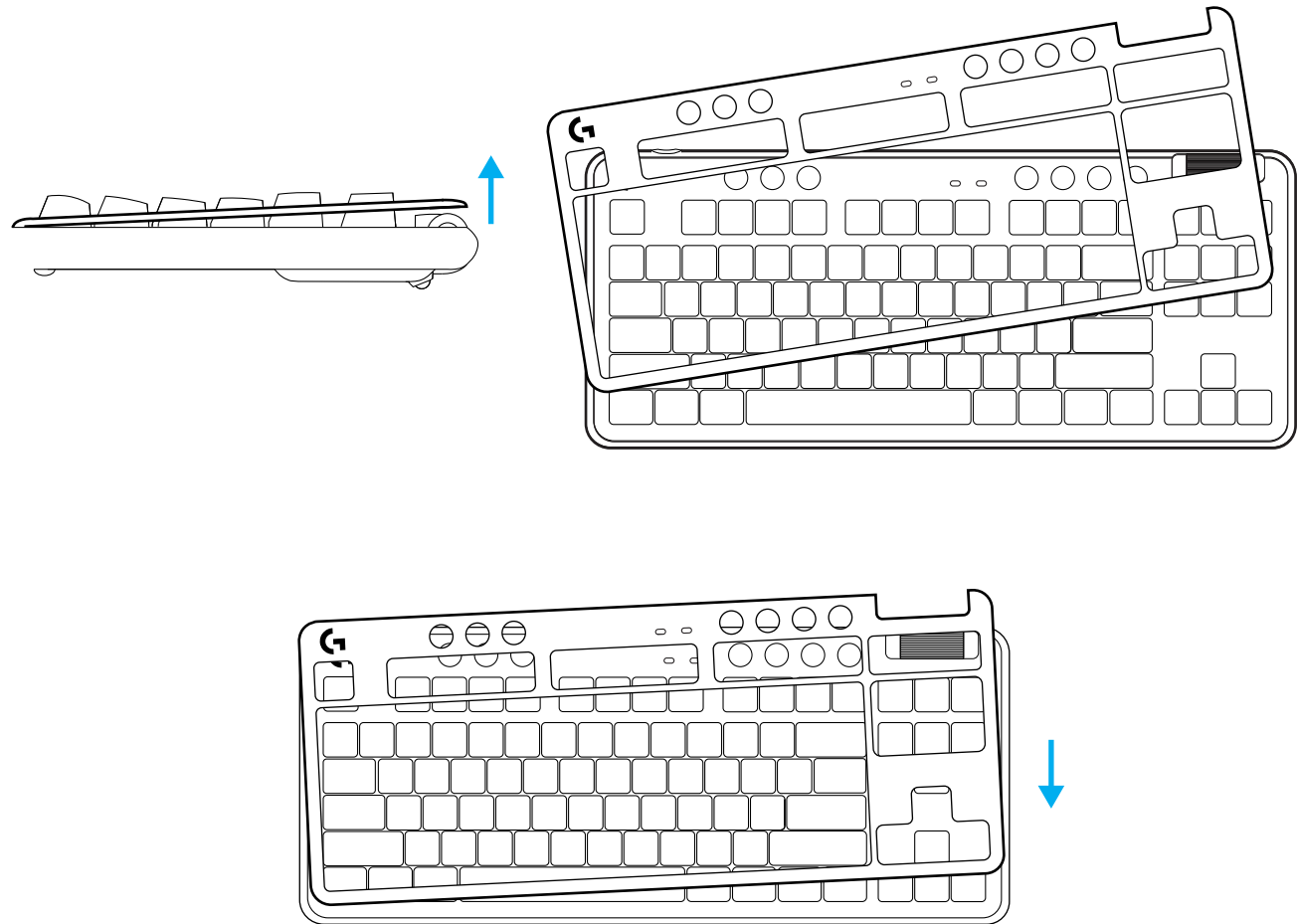

在 LIGHTSPEED 无线和蓝牙™ 设备之间切换

连接后，按下连接按钮切换连接方式。LIGHTSPEED 为浅青色，而蓝牙™ 为蓝色。

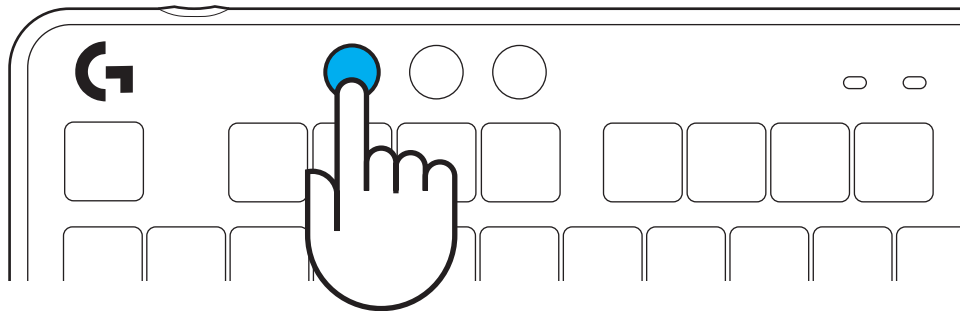

設定說明

1 從收納槽中取出 LIGHTSPEED 接收器。

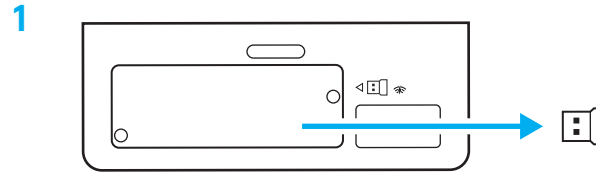

2 將附有延長器與連接線的 LIGHTSPEED 接收器插入 PC USB 連接埠。如果想要如此做的話，可以不附帶延長器和連接線，直接將接收器插入 USB 連接埠。

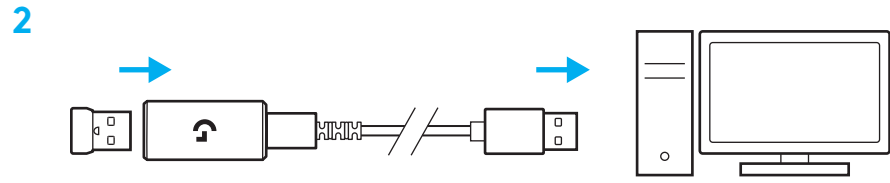

3 撥動電源按鈕開啓鍵盤電源。

連線按鈕會指示青色。

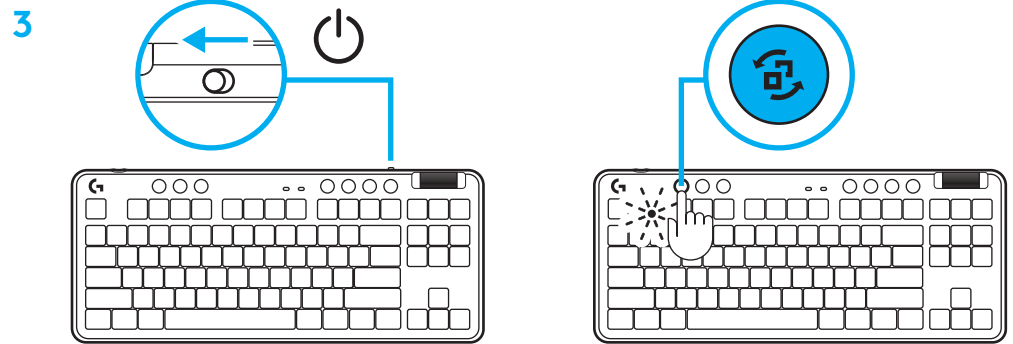

4 下載並安裝 G HUB 軟體到您的 PC/MAC，以獲得最佳遊戲體驗 (G HUB 提供有功能的介紹說明)。前往 www.logitechG.com/ghub



藍牙連線

1 撥動按鈕開啓鍵盤電源。

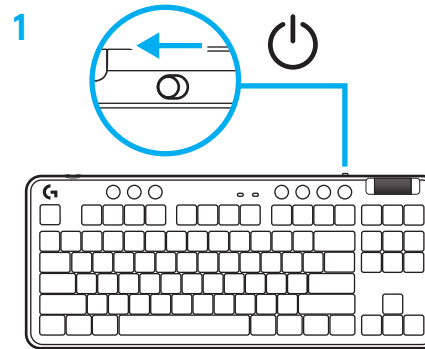

2 按下連線按鈕，循環切換到藍牙。指示燈會亮起藍燈並快速閃爍 - 此時為等待配對狀態。

使用您裝置的藍牙連線功能，將您的裝置與鍵盤配對。

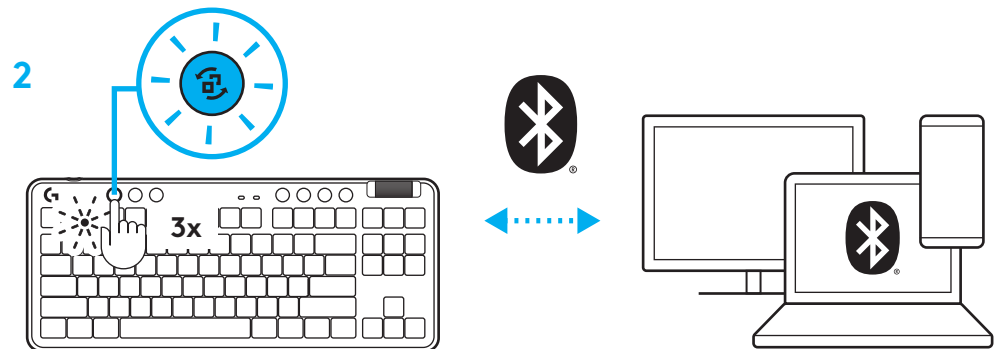

為鍵盤充電

- 1 將 USB-C 連接線插入鍵盤正面的連接埠。
- 2 將連接線連接到 PC。

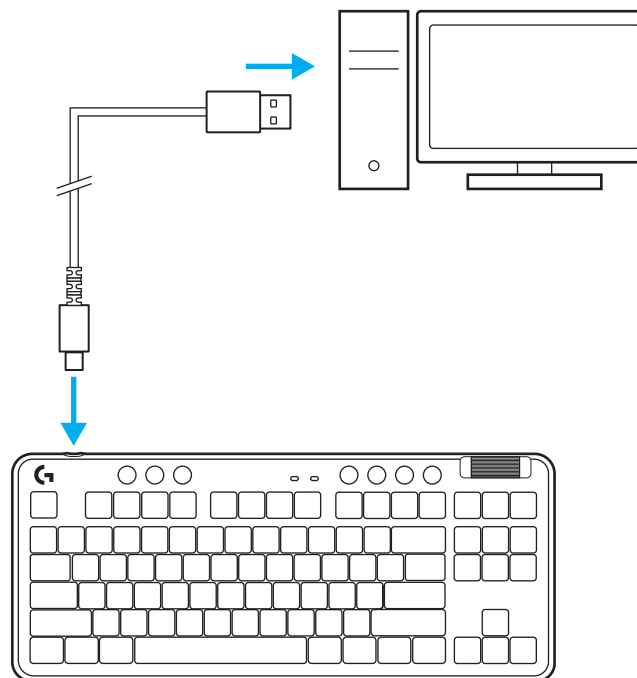

充電時電池指示燈會閃爍綠燈，完全充電後會亮起穩定綠燈。

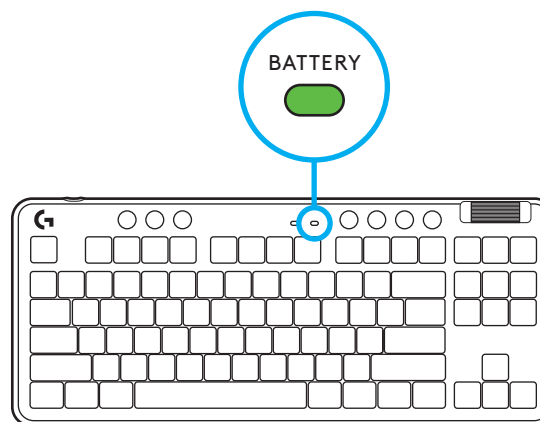

媒體控制鍵

G715 提供有媒體控制功能。向後快轉、播放/暫停、向前快轉和靜音鍵，配備有音量滾輪可控制您裝置的音量。

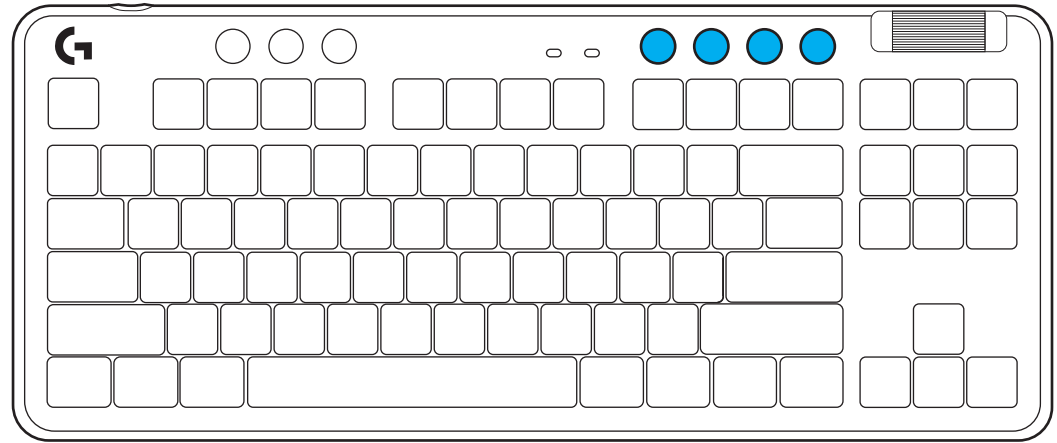

遊戲模式

按下游戲模式按鈕時可阻止 Windows 和功能表鍵起作用。其他按鍵可使用 G HUB 軟體封鎖其功能。

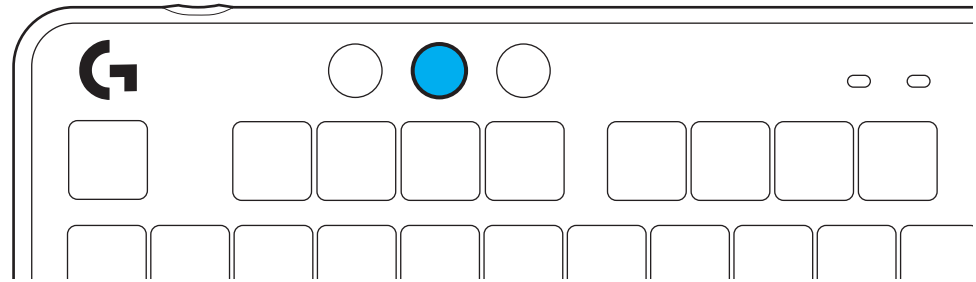

亮度

按下亮度按鈕可調整燈光亮度。

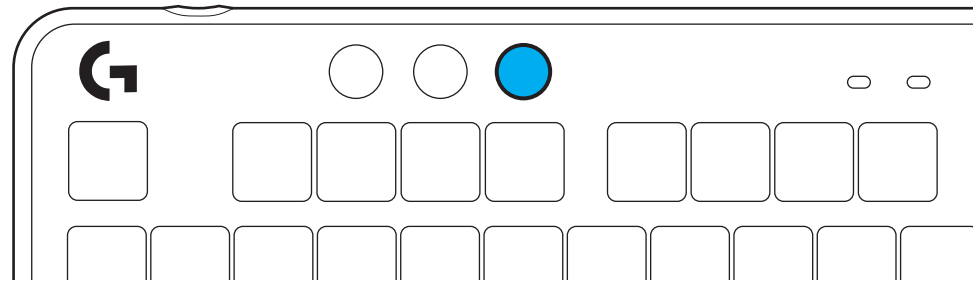

內建燈光效果

此鍵盤具有 8 種不同的燈光效果，這些效果儲存在其內建記憶體中。您可以按下亮度按鈕與這些按鍵，來選擇與修改這些效果：

亮度 + 1 = 彩虹 > 右

亮度 + 2 = 彩虹 > 左

亮度 + 3 = 彩虹中央向外擴散

亮度 + 4 = 彩虹 ^ 上

亮度 + 5 = 彩色圓環

亮度 + 6 = 按鍵波紋

亮度 + 7 = 青色呼吸效果

亮度 + 8 = 自訂燈光效果

亮度 + 9 = 自訂燈光效果

亮度 + 0 = 穩定青色

亮度 + - = 較慢的動畫效果

亮度 + = = 較快的動畫效果

G HUB 的燈光控制會覆寫這些設定。

更換上蓋板

上蓋板可以取下並更換為選用的配件上蓋板。

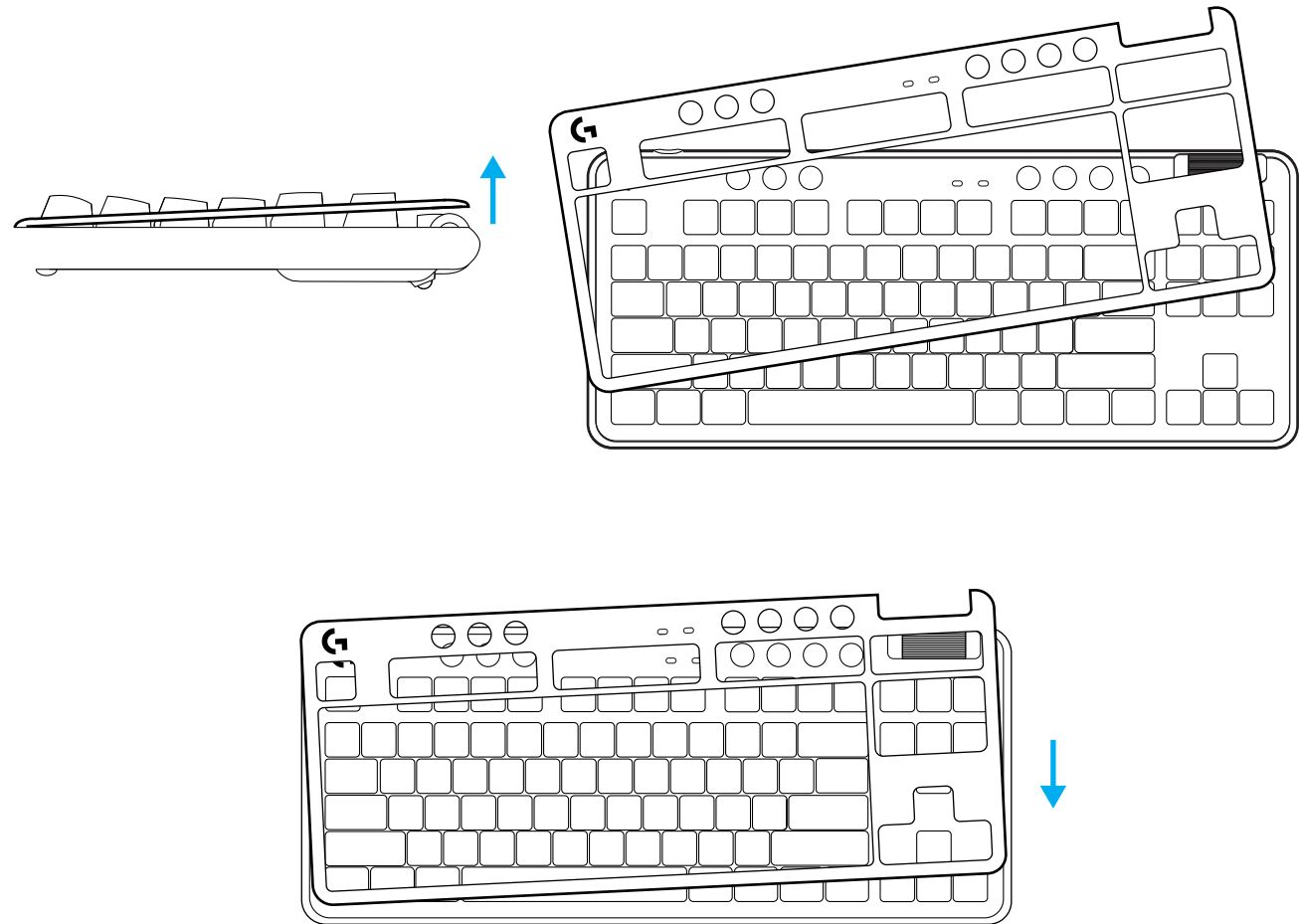

切換 LIGHTSPEED 無線與藍牙裝置

連線後，按下連線按鈕可切換連線。LIGHTSPEED 連線會亮起青燈，藍牙連線會亮起藍燈。

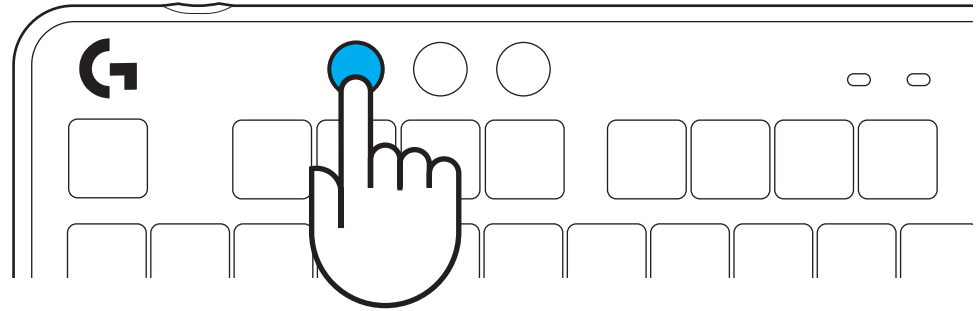

설치 지침

1 보관 슬롯에서 LIGHTSPEED 수신기를 꺼냅니다.

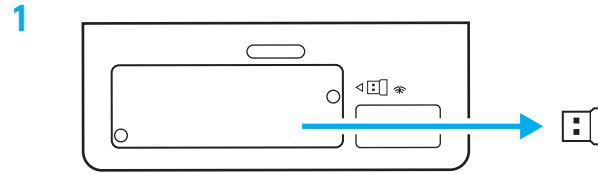

2 연장 케이블과 충전/데이터 케이블을 PC USB 포트에 연결하여 LIGHTSPEED 수신기를 연결합니다. 원하는 경우, USB 포트에 수신기를 직접 연결하여 연장 케이블과 충전/데이터 케이블 없이 사용할 수 있습니다.

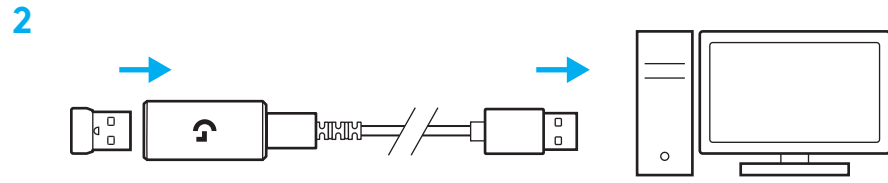

3 전원 버튼을 슬라이드하여 키보드를 켭니다.

연결 버튼이 청록색으로 켜집니다.

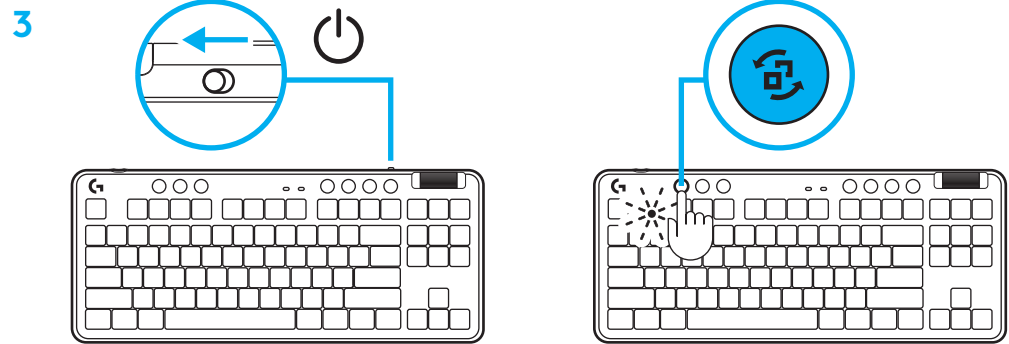

4 최고의 경험을 위해 PC/MAC에 G HUB 소프트웨어를 다운로드 및 설치합니다(G HUB에서 기능 확인 가능). www.logitechG.com/ghub로 이동



BLUETOOTH® 연결

1 버튼을 슬라이드하여 키보드를 켭니다.

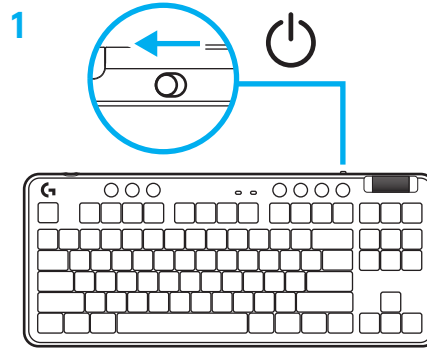

2 연결 버튼을 눌러 Bluetooth®로 전환합니다.
페어링 대기 중에는 조명이 파란색으로 켜지며 빠르게 깜박입니다.

장치의 Bluetooth® 연결을 따라 키보드와 페어링하십시오.

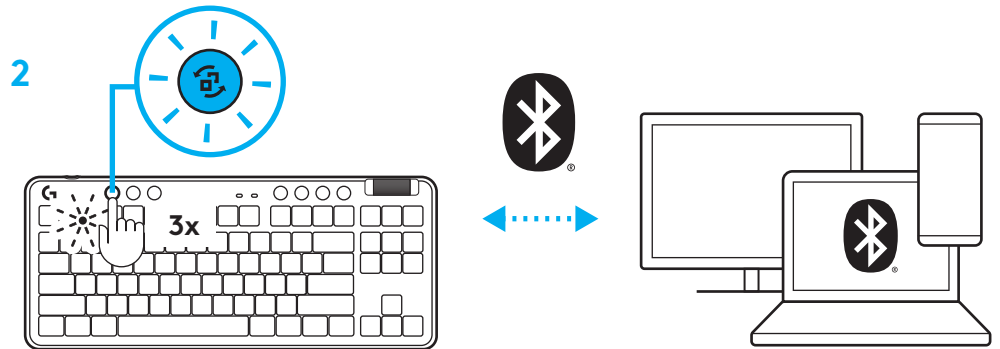

키보드 충전

- 1 USB-C 케이블을 키보드 전면에 있는 포트에 연결합니다.
- 2 PC에 케이블을 연결합니다.

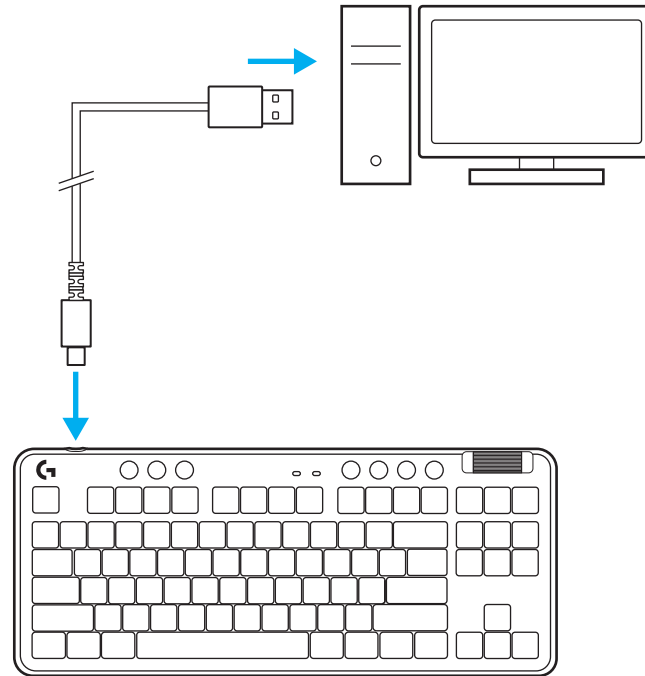

충전 중에는 배터리 표시등이 초록색으로 깜박이고 완전히 충전되면 초록색으로 유지됩니다.

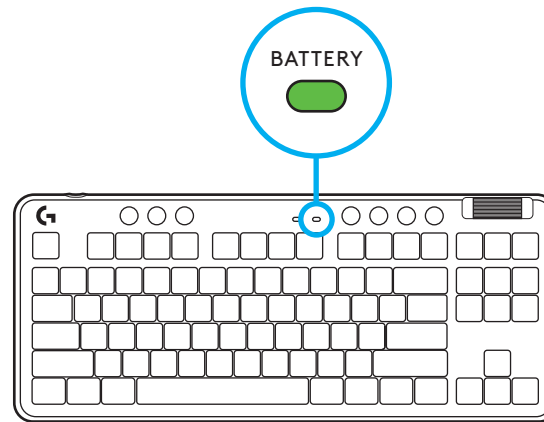

미디어 컨트롤

G715에는 미디어 컨트롤이 탑재되어 있습니다. 뒤로 건너뛰기, 재생/일시 정지, 앞으로 감기, 음소거 키와 장치 볼륨을 컨트롤하는 볼륨 롤러도 이용 가능합니다.

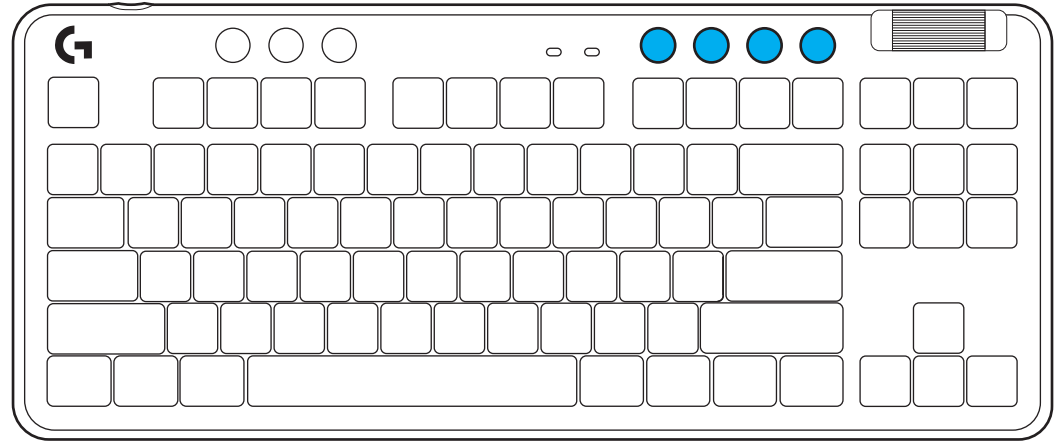

게임 모드

게임 모드 버튼을 누르면 Windows 및 메뉴 키가 눌리지 않습니다. G HUB 소프트웨어로 다른 키도 차단할 수 있습니다.

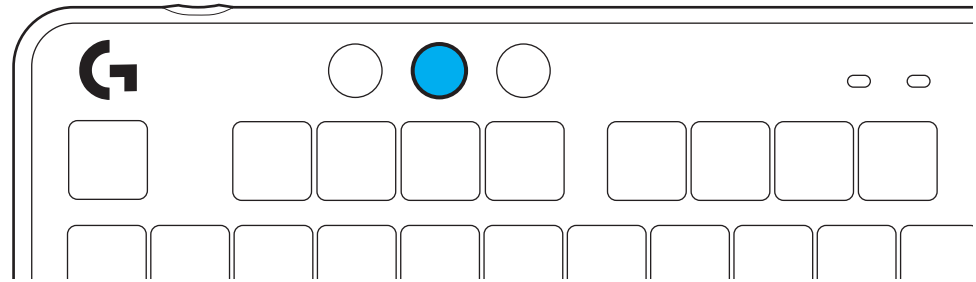

밝기

밝기 버튼을 눌러 조명 밝기를 조절해보세요.

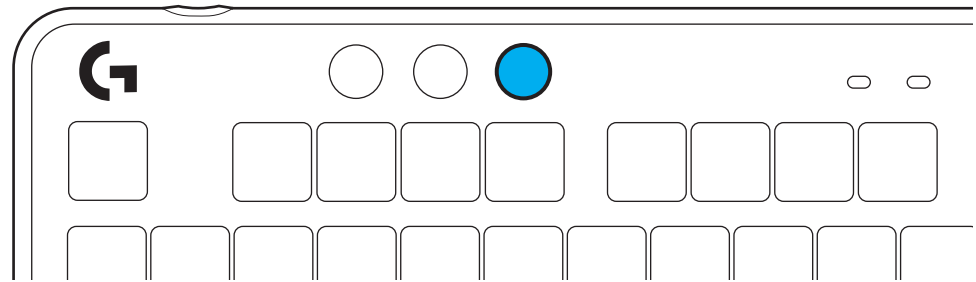

온보드 조명 효과

키보드의 온보드 메모리에 8개의 다양한 조명 효과가 저장되어 있습니다. 밝기 버튼과 다음 키를 눌러 이를 선택 및 편집할 수 있습니다.

밝기 + 1 = 무지개 > 오른쪽

밝기 + 2 = 무지개 > 왼쪽

밝기 + 3 = 무지개 중앙

밝기 + 4 = 무지개 ^ 위로

밝기 + 5 = 컬러 순환

밝기 + 6 = 키 입력 반응

밝기 + 7 = 청록색 일렁임

밝기 + 8 = 커스텀 조명 효과

밝기 + 9 = 커스텀 조명 효과

밝기 + 0 = 청록색 유지

밝기 + - = 애니메이션 느리게

밝기 + = = 애니메이션 빠르게

G HUB를 통한 조명 설정은 이 설정을 덮어씁니다.

탑 플레이트 변경

탑 플레이트를 떼고 액세서리 탑 플레이트(옵션)로 교체할 수 있습니다.

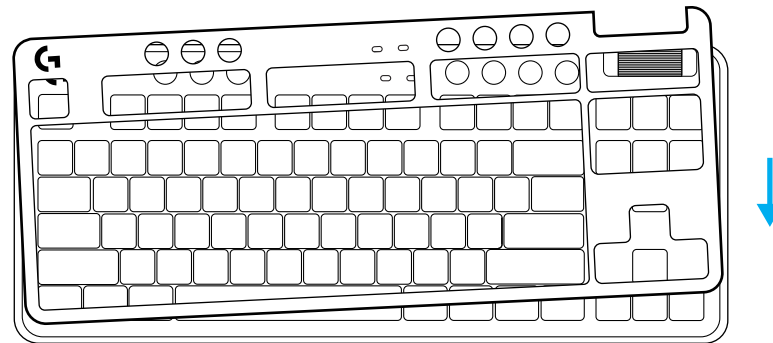
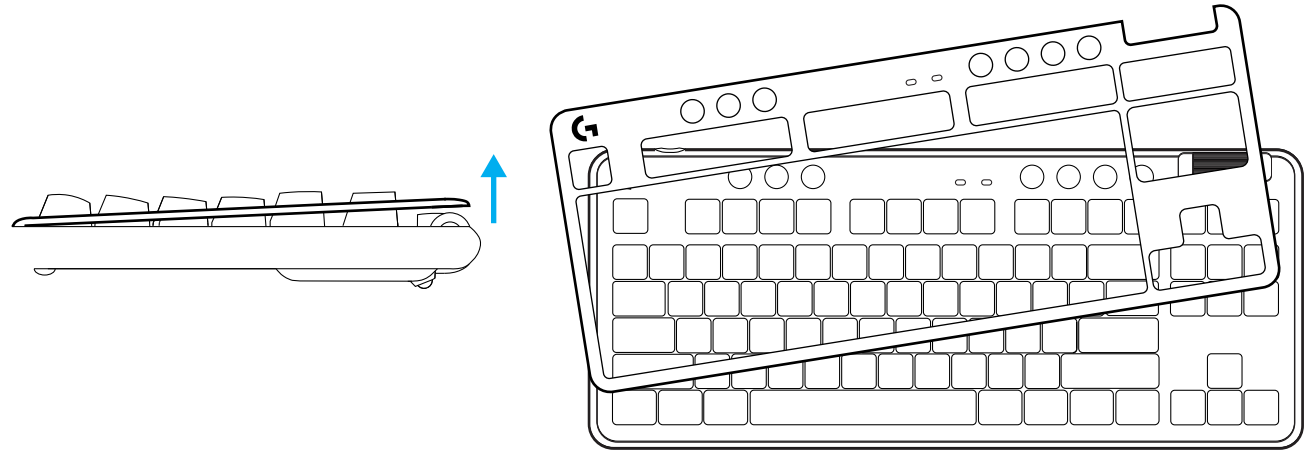

LIGHTSPEED 무선 및 *BLUETOOTH*® 장치 전환

장치에 연결된 후 연결 버튼을 눌러 연결을 전환할 수 있습니다. LIGHTSPEED는 청록색, *Bluetooth*®는 파란색입니다.

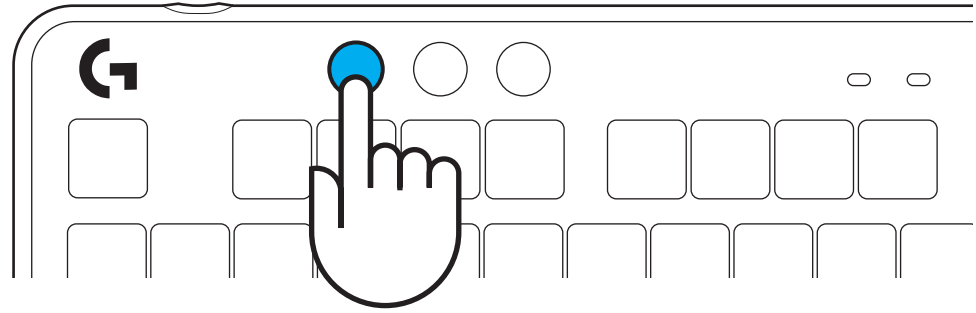



© 2022 Logitech. Logitech, Logitech G, Logi and their respective logos are trademarks or registered trademarks of Logitech Europe S.A. and/or its affiliates in the U.S. and other countries. All other trademarks are the property of their respective owners. Logitech assumes no responsibility for any errors that may appear in this manual. Information contained herein is subject to change without notice. The *Bluetooth*® word mark and logos are registered trademarks owned by Bluetooth SIG, Inc. and any use of such marks by Logitech is under license.

版权所有 © 2022 罗技。罗技、罗技 G、Logi、Logitech、Logitech G 及其各自标志为 Logitech Europe S.A. 和/或其在美国及其他国家/地区附属公司的商标或注册商标。所有其它商标均是其各自所有者的财产。罗技对于本手册中可能出现的任何错误不承担任何责任。本手册中包含的信息如有更改，恕不事先通知。蓝牙™ 文字商标和标志为 Bluetooth SIG, Inc. 所有的注册商标，罗技对此类商标和标志的所有使用均已获得授权。