

LOGITECH G PRO X TKL

LIGHTSPEED Wireless Gaming Keyboard | LIGHTSPEED 无线游戏键盘

LIGHTSPEED 無線遊戲鍵盤 | LIGHTSPEED 무선 게이밍 키보드

SETUP GUIDE | 设置指南

設定指南 | 설치 가이드



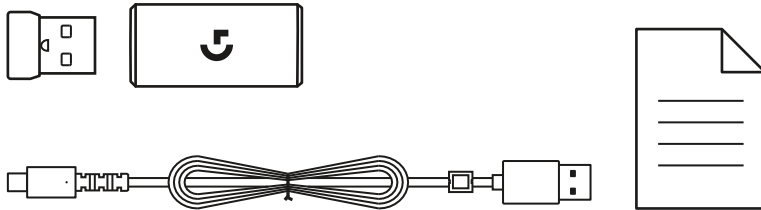
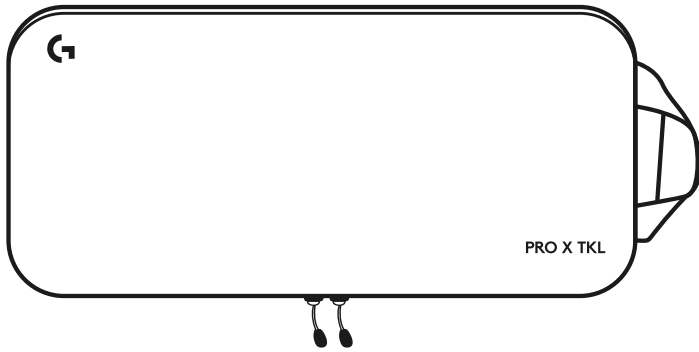
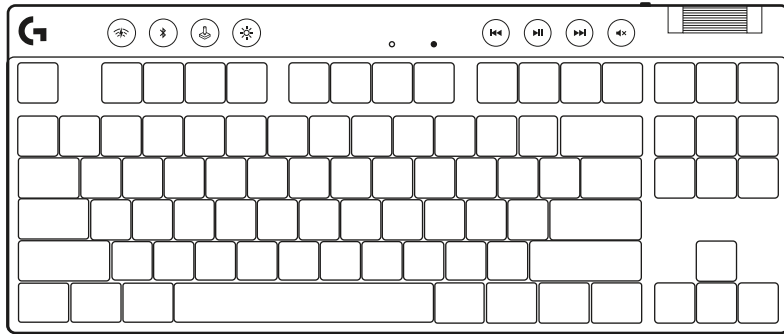

ENGLISH 3

简体中文 9

繁體中文 15

한국어 21

SETUP INSTRUCTIONS

- 1 Remove keyboard, receiver/adaptor assembly, and USB cable from carrying case.

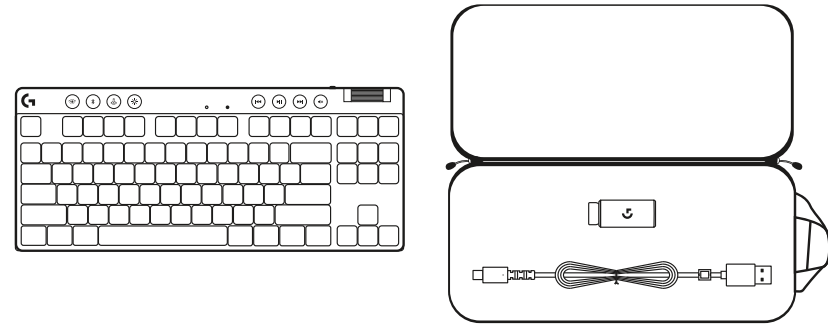

- 2 Insert the LIGHTSPEED receiver, with extender and cable into the PC USB port. Receiver can be used without the extender and cable by inserting it directly into a USB port if desired.

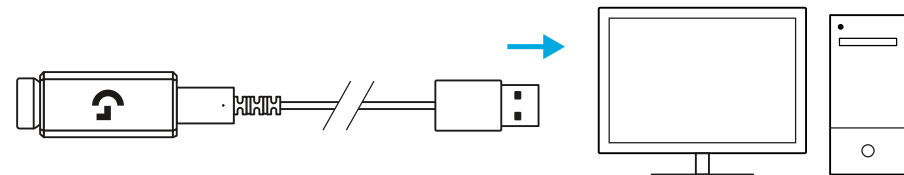

- 3 Turn on the keyboard by sliding the power button. The LIGHTSPEED button will light up to a cyan color.

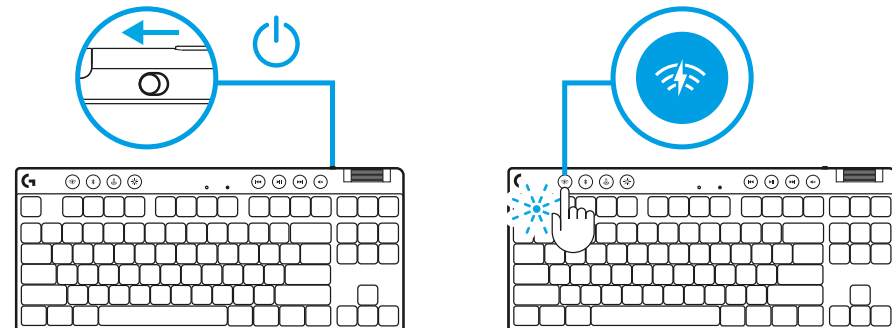

- 4 Download and install G HUB software to your PC/MAC for the best gaming experience (G HUB has onboarding story for features). Go to logitechG.com/ghub

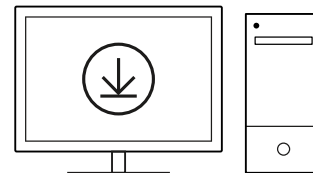

logitechG.com/ghub

BLUETOOTH® CONNECTIVITY

1 Turn on the keyboard by sliding the button.

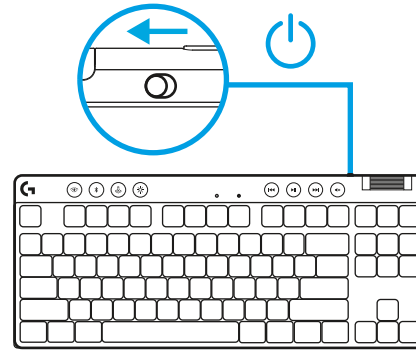

2 Press *Bluetooth*® button to select *Bluetooth*®. If there is no *Bluetooth*® device paired, the light will flash quickly - waiting to pair.

Follow *Bluetooth*® connection for your device to pair with the keyboard.

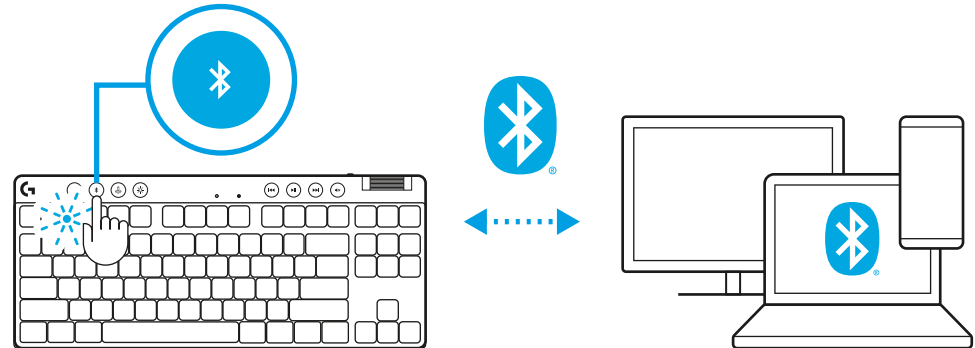

CHARGING YOUR KEYBOARD

- 1 Insert the *USB-C* cable into the port at the front of the keyboard.
- 2 Connect the cable to your PC.

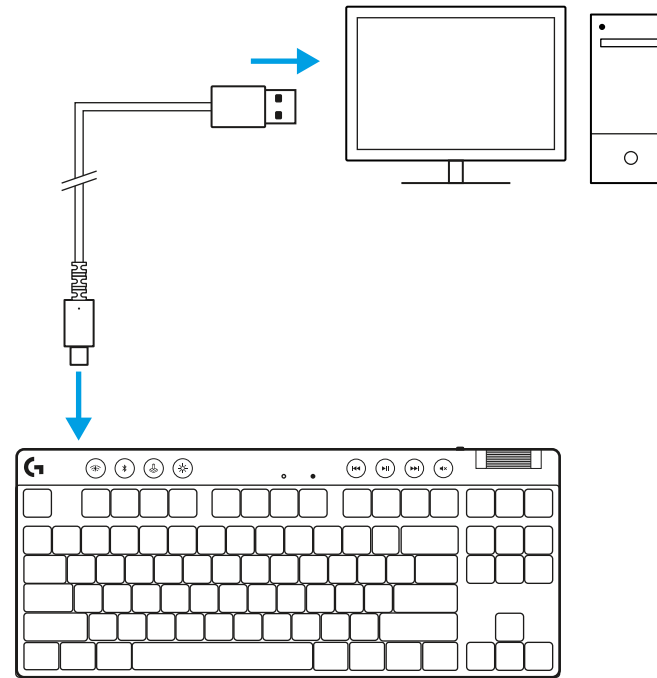

Battery indicator light will pulse green while charging and be solid green when fully charged.

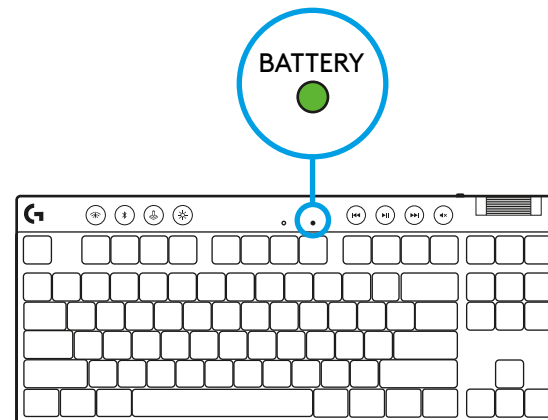

ONBOARD LIGHTING EFFECTS

The keyboard has 8 different lighting effects stored in its onboard memory. You can select and modify these by pressing the Brightness button and these keys:

Brightness + 1 = Rainbow > right

Brightness + 2 = Rainbow > left

Brightness + 3 = Rainbow center out

Brightness + 4 = Rainbow ^ up

Brightness + 5 = Color cycle

Brightness + 6 = Keystroke ripple

Brightness + 7 = Breathing cyan

Brightness + 8 = Custom lighting effect

Brightness + 9 = Custom lighting effect

Brightness + 0 = Solid cyan

Brightness + - = Animation slower

Brightness + = = Animation faster

G HUB lighting controls will override these settings.

SWITCH BETWEEN LIGHTSPEED WIRELESS AND *BLUETOOTH*[®] DEVICES

Once connected, press the LIGHTSPEED button to choose the LIGHTSPEED connection, or the *Bluetooth*[®] button to choose the *Bluetooth*[®] connection, if you would like to type on different connected devices.

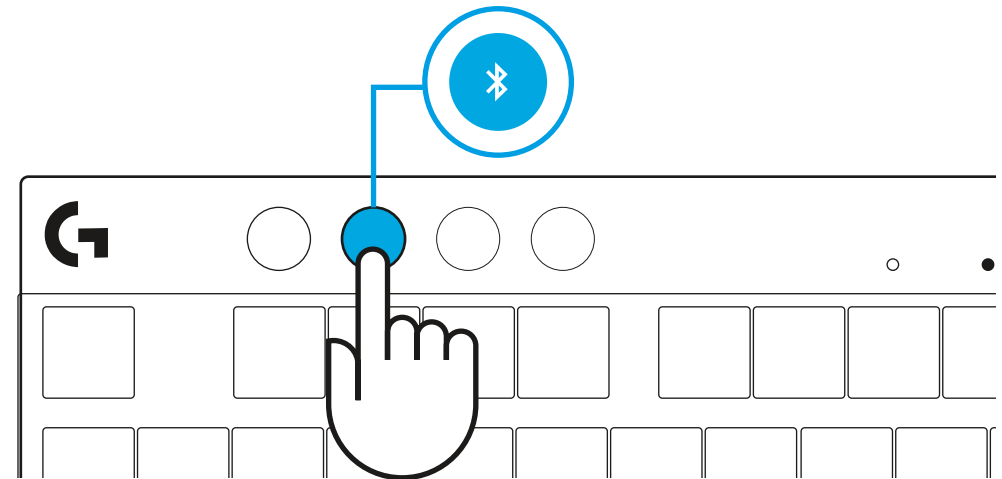
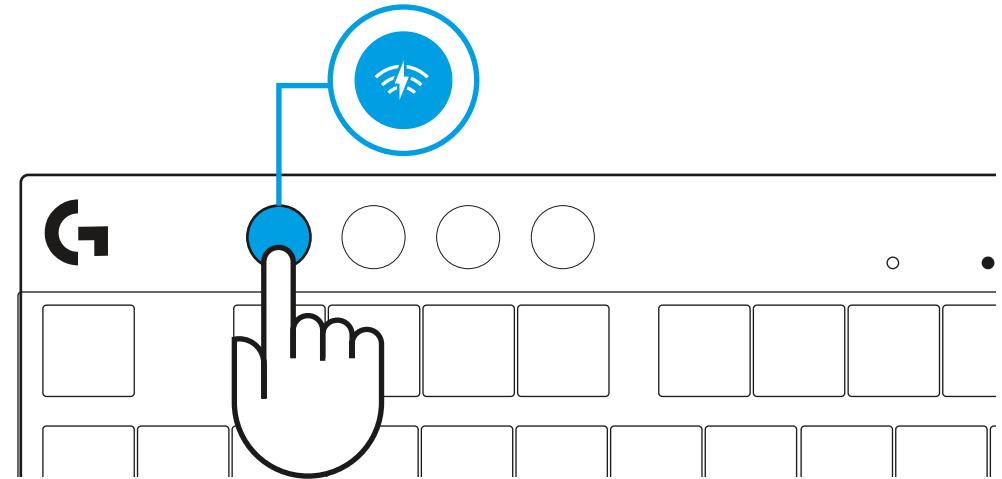

设置说明

1 从收纳包中取出键盘、接收器/适配器组件和 USB 线缆。

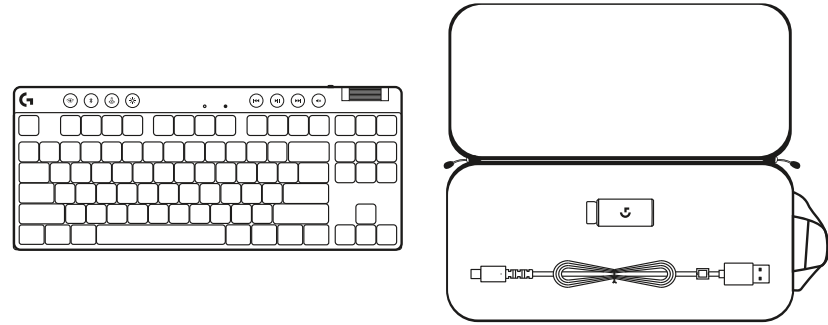

2 将 LIGHTSPEED 接收器插入扩展器, 将线缆插入 PC USB 端口。
可以根据需要直接将接收器插入 USB 端口, 无需扩展器和线缆即可使用。

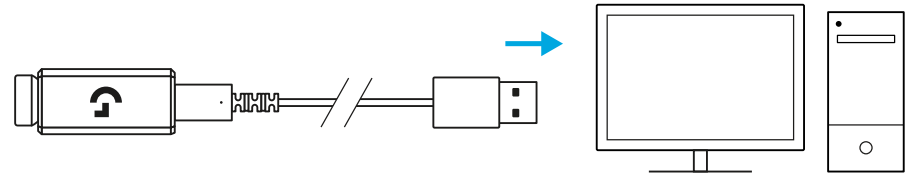

3 拨动电源按钮, 打开键盘。
LIGHTSPEED 按钮将亮起青色。

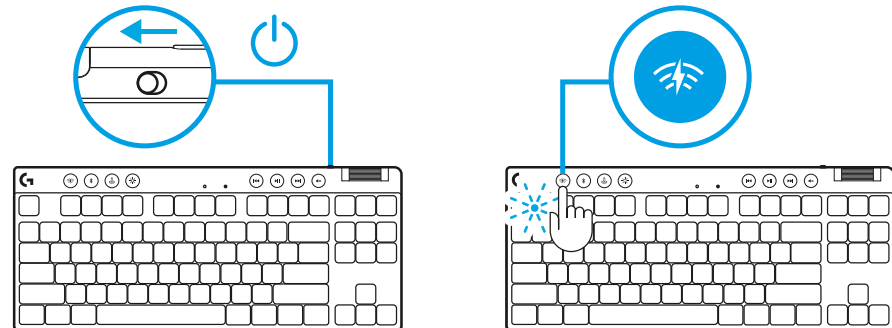

4 下载 G HUB 软件并安装到 PC/MAC, 获得更出色的游戏体验 (G HUB 包含有关各项功能的入门介绍)。访问 logitechG.com/ghub

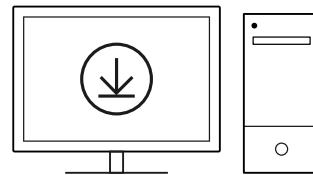

logitechG.com/ghub

蓝牙™ 连接

1 拨动按钮, 打开键盘。

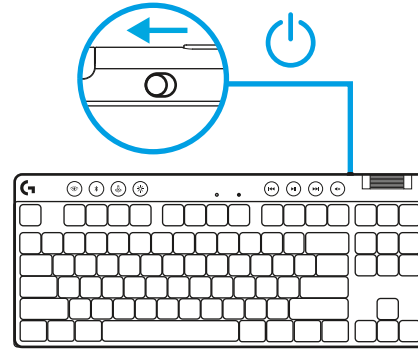

2 按下蓝牙™ 按钮选择蓝牙™。如果没有已配对的蓝牙™ 设备, 指示灯将快速闪烁 - 等待配对。

按照蓝牙™ 连接步骤操作, 将设备与键盘配对。

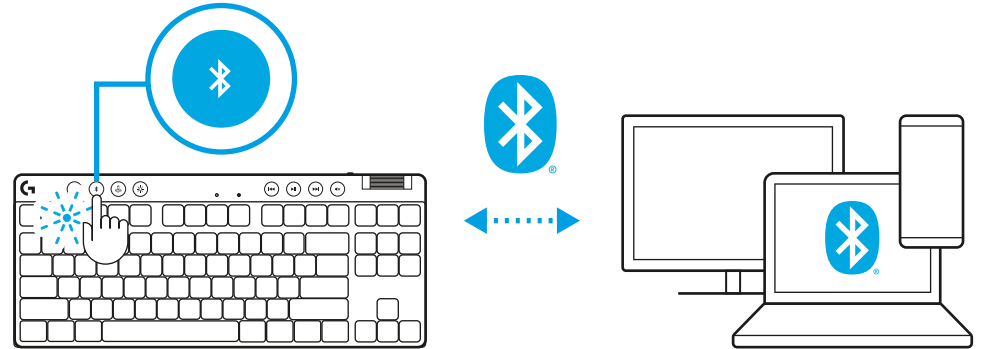

为键盘充电

- 1 将 USB-C 线缆插入键盘正面的端口。
- 2 将线缆连接至 PC。

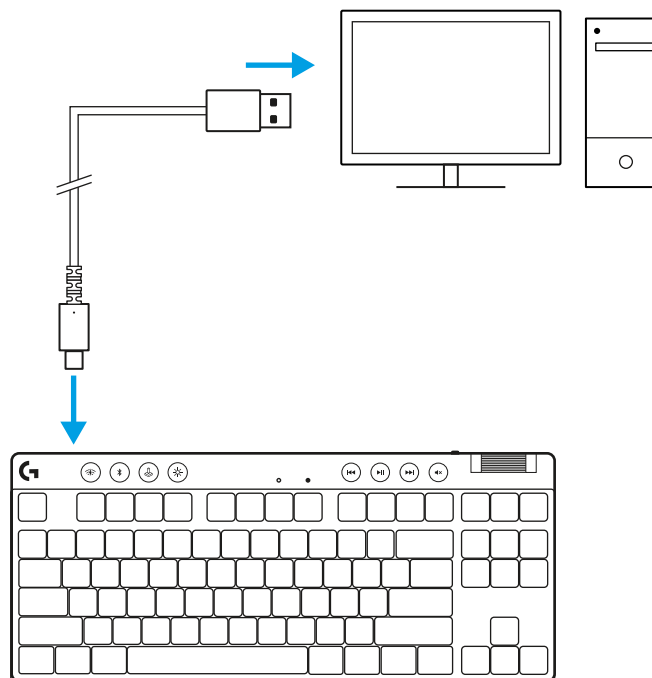

电量指示灯在充电时闪烁绿色, 充满电后常亮绿色。

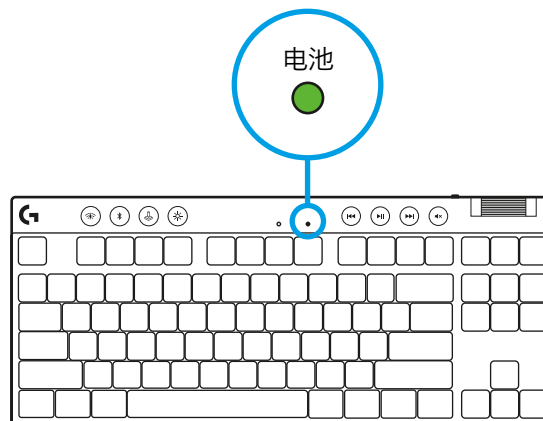

媒体控制

PRO X TKL 包含媒体控制按钮。上一曲、播放/暂停、下一曲和静音键, 使用音量滚轮控制您的设备音量。

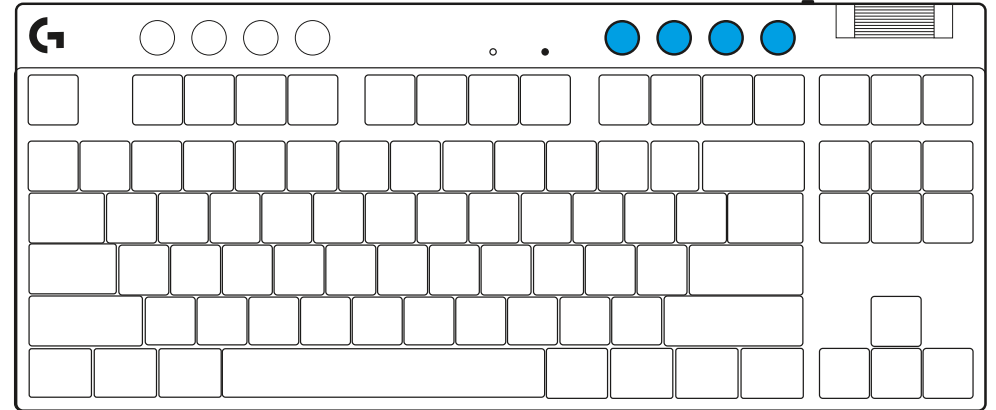

游戏模式

按下游戏模式按钮后会阻止 Windows 和相关菜单键功能。可以使用 G HUB 软件阻止其他按键。

游戏模式锁定 (FN+游戏模式), 锁定游戏模式按钮, 防止游戏模式被打开或关闭。

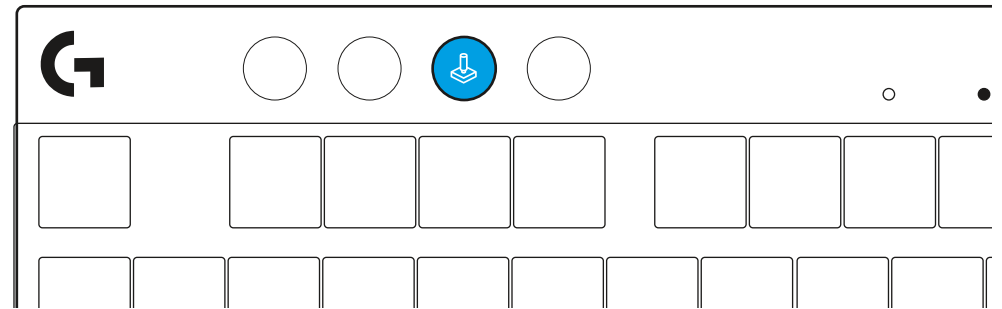

亮度

按下亮度按钮调节灯光亮度。

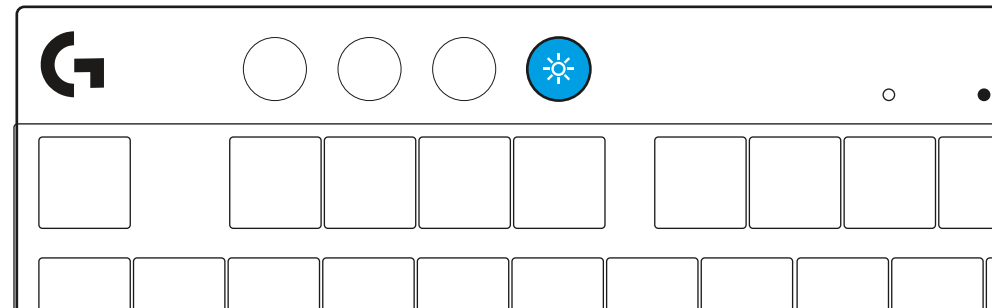

板载灯光效果

键盘在其板载内存中存储了 8 种不同的灯光效果。您可以按下亮度按钮和以下按键来选择和改变灯光效果：

亮度 + 1 = 彩虹 > 右

亮度 + 2 = 彩虹 > 左

亮度 + 3 = 彩虹从中心向外扩散

亮度 + 4 = 彩虹 ^ 上

亮度 + 5 = 色彩循环

亮度 + 6 = 击键波纹

亮度 + 7 = 青色呼吸灯

亮度 + 8 = 自定义灯光效果

亮度 + 9 = 自定义灯光效果

亮度 + 0 = 常亮青色

亮度 + - = 动画效果减速

亮度 + + = 动画效果加速

G HUB 灯光控制将覆盖这些设置。

在 LIGHTSPEED 无线和蓝牙™ 设备之间切换

连接后, 按下 LIGHTSPEED 按钮选择 LIGHTSPEED 连接, 或者如果您想在不同的连接设备上输入, 按下蓝牙™ 按钮选择蓝牙™ 连接。

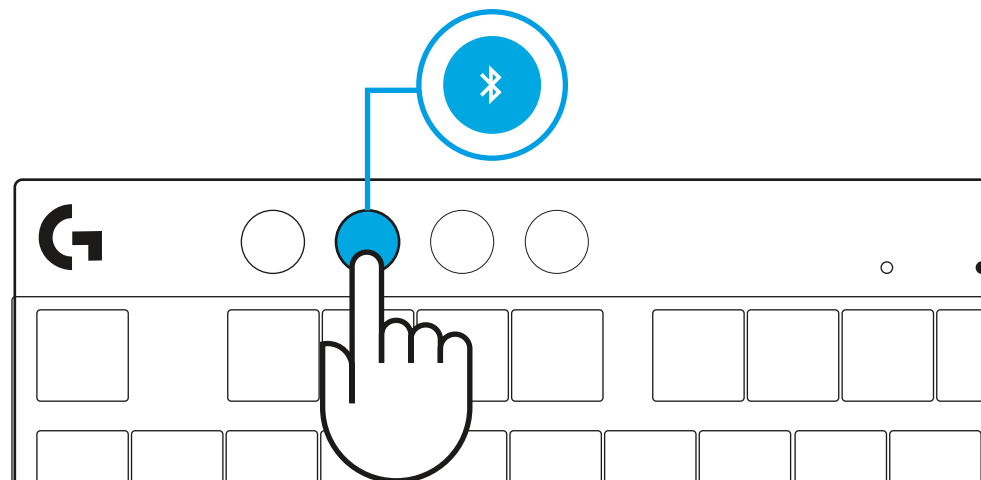
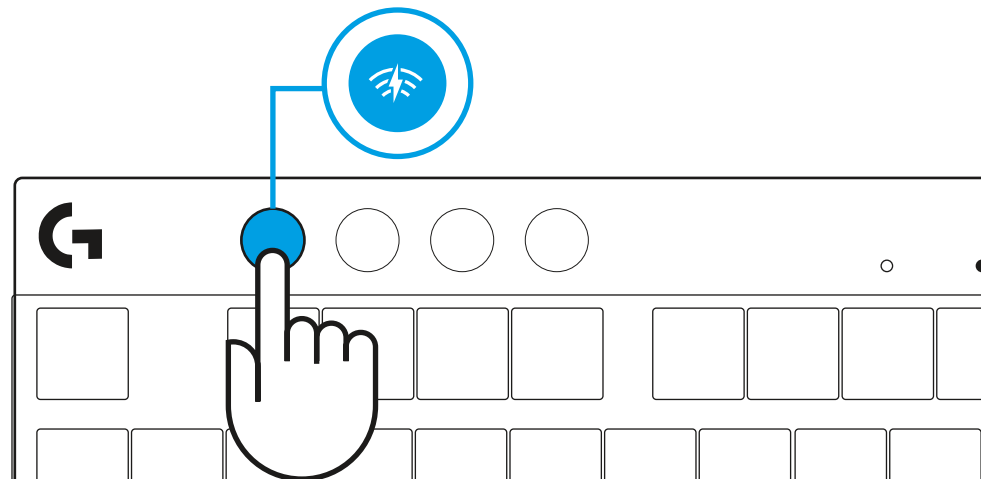

設定指示說明

1 從收納盒中取出鍵盤、接收器/轉接器組件、以及 USB 連接線。

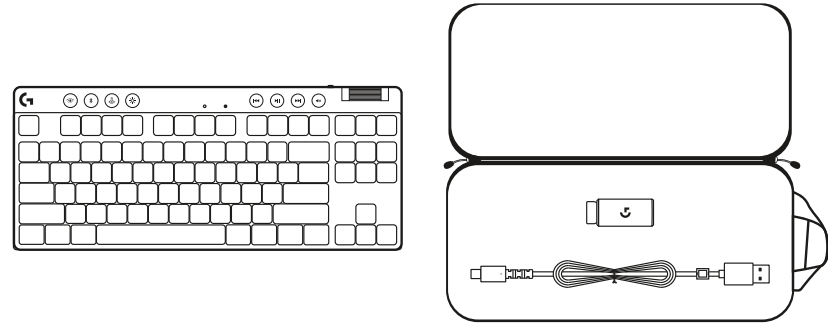

2 將附有延長器與連接線的 LIGHTSPEED 接收器插入 PC USB 連接埠。可以不附帶延長器和連接線，直接將接收器插入 USB 連接埠。

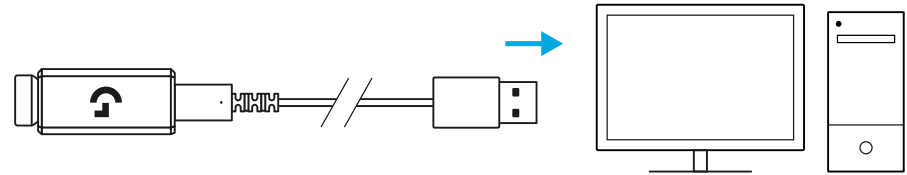

3 撥動電源按鈕開啓鍵盤電源。
LIGHTSPEED 按鈕會亮起青色燈號。

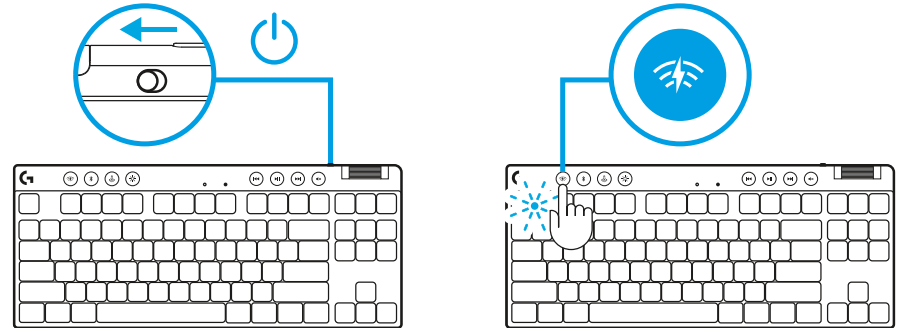

4 下載並安裝 G HUB 軟體到您的 PC/MAC，以獲得最佳遊戲體驗 (G HUB 提供有功能的介紹說明)。前往 logitechG.com/ghub

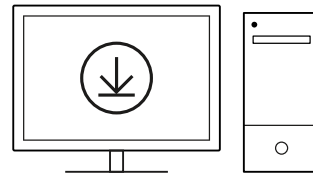

logitechG.com/ghub

藍牙連線

1 撥動按鈕開啓鍵盤電源。

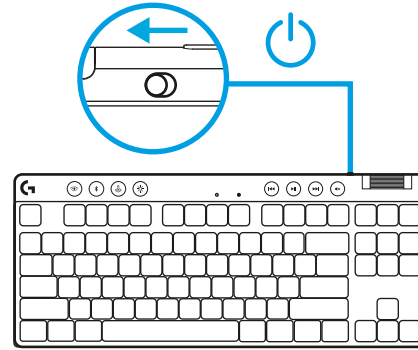

2 按下藍牙按鈕以選擇藍牙。如果沒有已配對的藍牙裝置，指示燈會快速閃爍，表示其處於等待配對狀態。

使用您裝置的藍牙連線功能，將您的裝置與鍵盤配對。

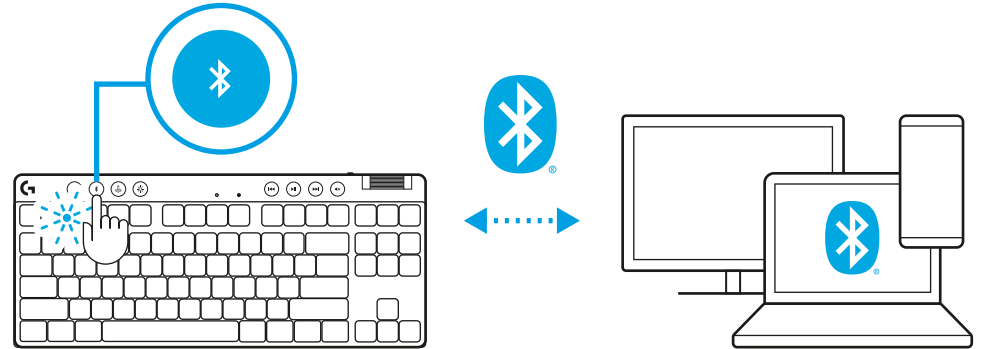

為鍵盤充電

- 1 將 USB-C 連接線插入鍵盤正面的連接埠。
- 2 將連接線連接到 PC。

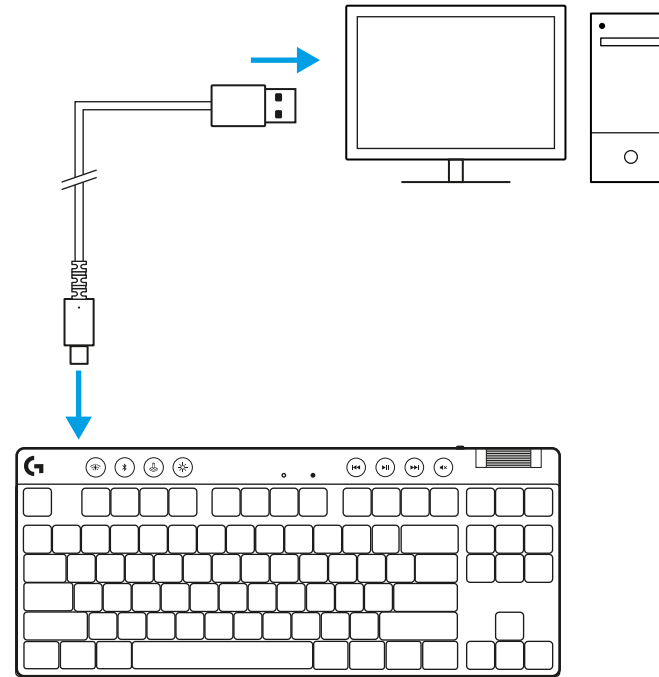

充電時電池指示燈會閃爍綠燈，完全充電後會亮起穩定綠燈。

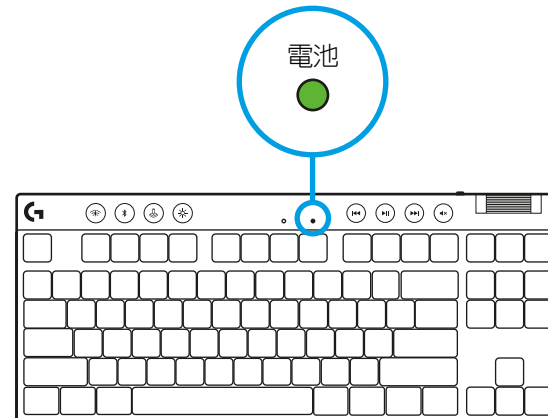

媒體控制鍵

PRO X TKL 提供有媒體控制功能。向後快轉、播放/暫停、向前快轉和靜音鍵，配備有音量滾輪可控制您裝置的音量。

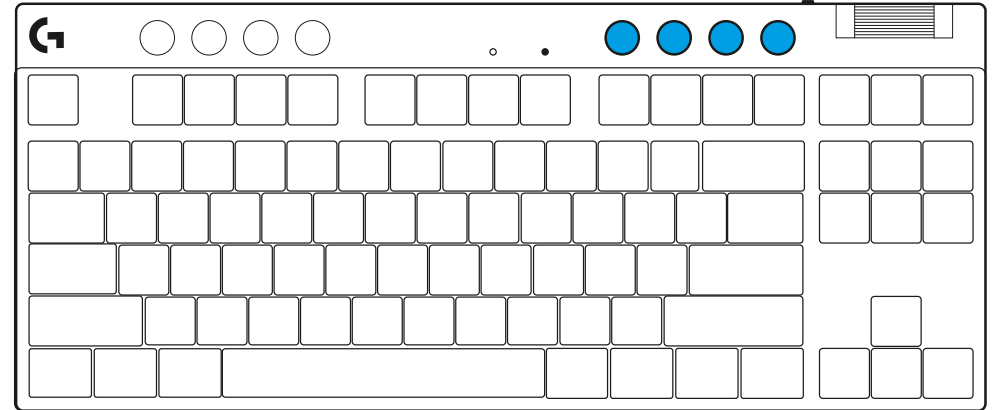

遊戲模式

按下游戲模式按鈕時可阻止 Windows 和右鍵功能表鍵起作用。其他按鍵可使用 G HUB 軟體封鎖其功能。

遊戲模式鎖定 (FN+遊戲模式) 可鎖定遊戲模式按鈕，並防止開啓或關閉遊戲模式。

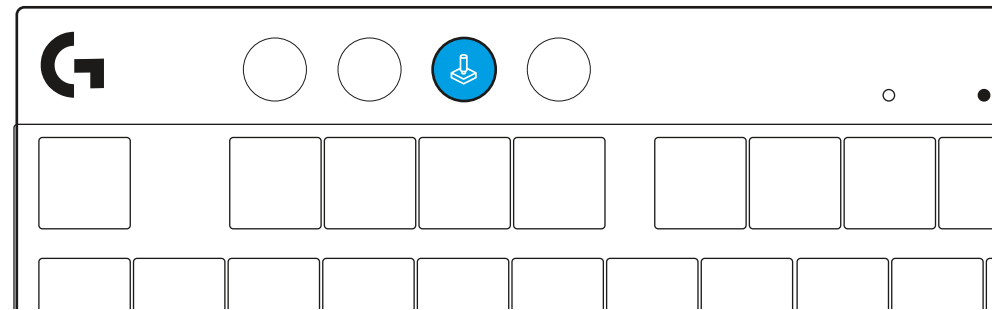

亮度

按下亮度按鈕可調整燈光亮度。

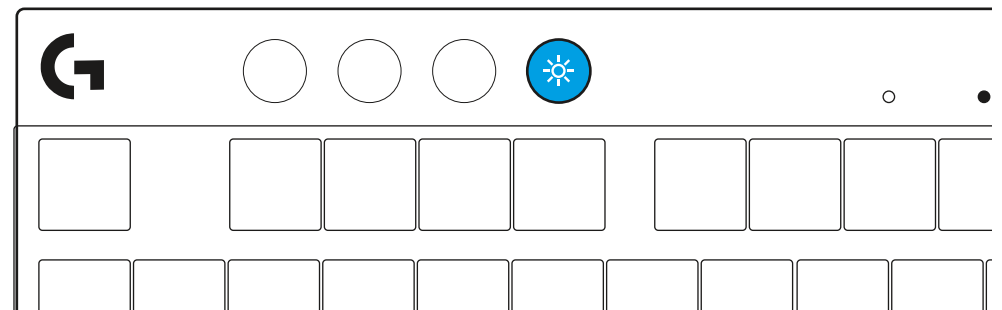

內建燈光效果

此鍵盤具有 8 種不同的燈光效果，這些效果儲存在其內建記憶體中。您可以按下亮度按鈕與這些按鍵，來選擇與修改這些效果：

亮度 + 1 = 彩虹 > 右

亮度 + 2 = 彩虹 > 左

亮度 + 3 = 彩虹中央向外擴散

亮度 + 4 = 彩虹 ^ 上

亮度 + 5 = 彩色圓環

亮度 + 6 = 按鍵波紋

亮度 + 7 = 青色呼吸效果

亮度 + 8 = 自訂燈光效果

亮度 + 9 = 自訂燈光效果

亮度 + 0 = 穩定青色

亮度 + - = 較慢的動畫效果

亮度 + = = 較快的動畫效果

G HUB 的燈光控制會覆寫這些設定。

切換 LIGHTSPEED 無線與藍牙裝置

如果您要在不同的連線裝置上打字，在建立連線後，按下 LIGHTSPEED 按鈕可選擇 LIGHTSPEED 連線，或按下藍牙按鈕可選擇藍牙連線。

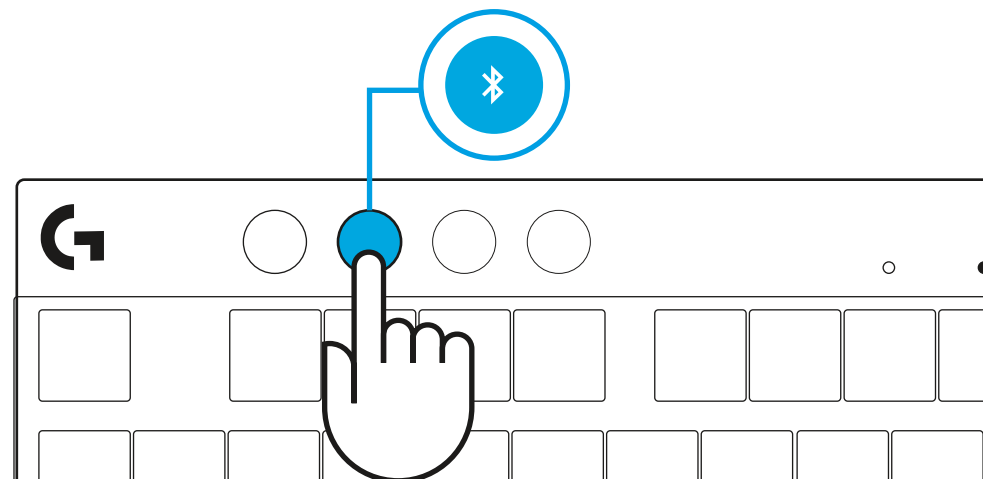
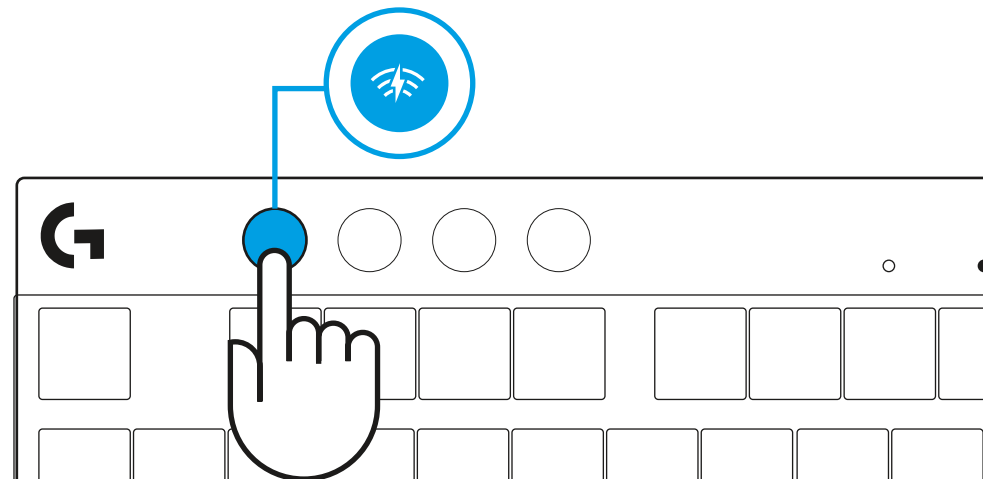

설치 지침

1 휴대용 케이스에서 키보드, 수신기/어댑터 부품, USB 케이블을 꺼냅니다.

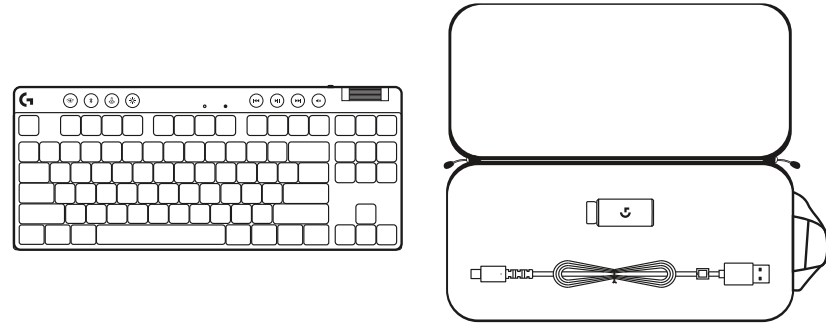

2 연장 케이블과 케이블을 PC USB 포트에 연결하여 LIGHTSPEED 수신기를 연결합니다. 원하는 경우, USB 포트에 수신기를 직접 연결하여 연장 케이블과 케이블 없이 사용할 수 있습니다.

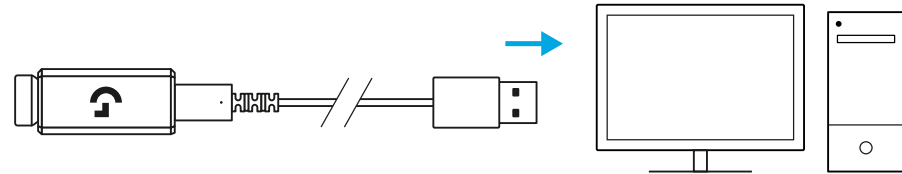

3 전원 버튼을 슬라이드하여 키보드를 켭니다. LIGHTSPEED 버튼이 청록색으로 켜집니다.

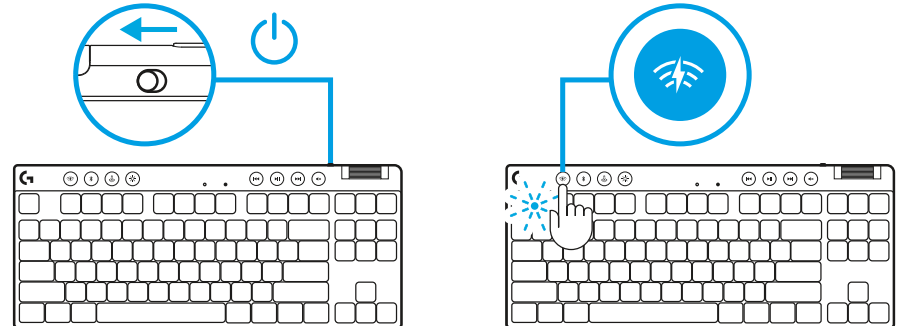

4 최고의 경험을 위해 PC/MAC에 G HUB 소프트웨어를 다운로드 및 설치합니다(G HUB에서 기능 확인 가능). logitechG.com/ghub로 이동하세요.

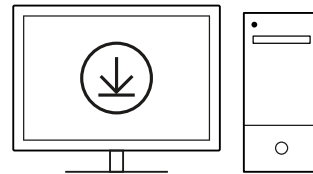

logitechG.com/ghub

BLUETOOTH® 연결

1 버튼을 슬라이드하여 키보드를 켭니다.

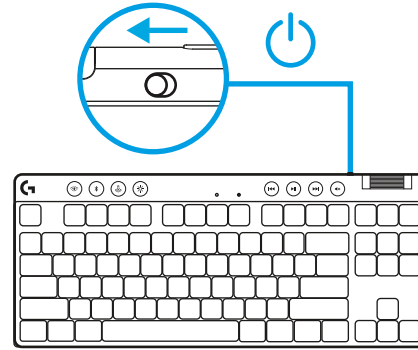

2 Bluetooth® 버튼을 눌러 Bluetooth®를 선택합니다. 페어링된 Bluetooth® 장치가 없는 경우, 표시등이 페어링 대기 상태로 빠르게 깜박입니다.

장치의 Bluetooth® 연결 지침을 따라 키보드와 페어링하세요.

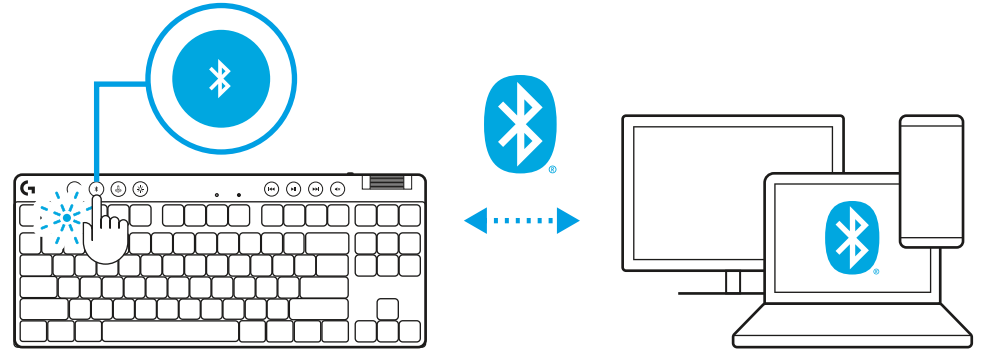

키보드 충전

- 1 USB-C 케이블을 키보드 전면에 있는 포트에 연결합니다.
- 2 PC에 케이블을 연결합니다.

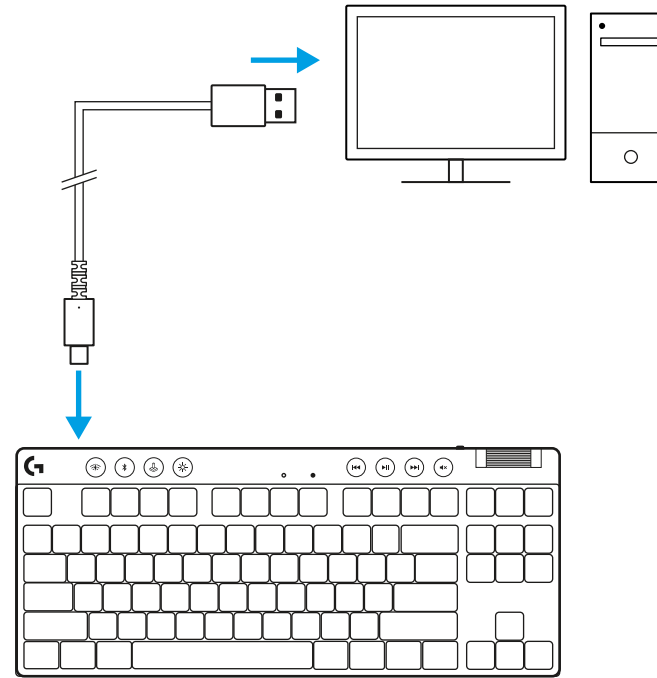

충전 중에는 배터리 표시등이 초록색으로 깜박이고 완전히 충전되면 초록색으로 유지됩니다.

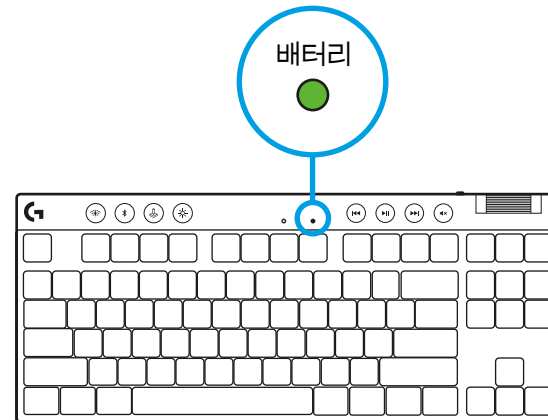

미디어 컨트롤

PRO X TKL에는 미디어 컨트롤이 탑재되어 있습니다. 뒤로 건너뛰기, 재생/일시 정지, 앞으로 감기, 음소거 키와 장치 볼륨을 컨트롤하는 볼륨 롤러도 이용 가능합니다.

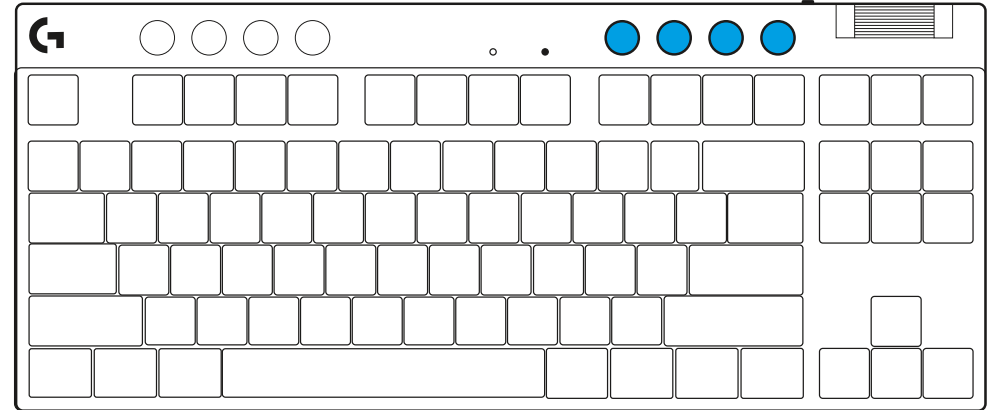

게임 모드

게임 모드 버튼을 누르면 Windows 및 컨텍스트 메뉴 키가 눌리지 않습니다. G HUB 소프트웨어로 다른 키도 차단할 수 있습니다.

게임 모드 잠금(FN+게임 모드)는 게임 모드 버튼을 잠가 게임 모드가 켜지거나 꺼지지 않게 예방합니다.

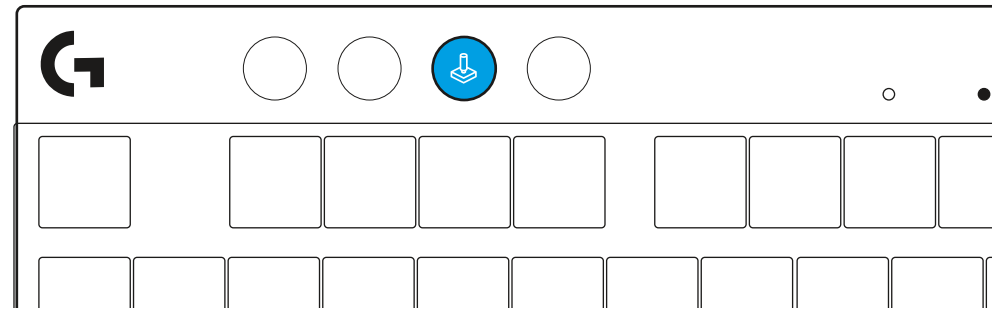

밝기

밝기 버튼을 눌러 조명 밝기를 조절해보세요.

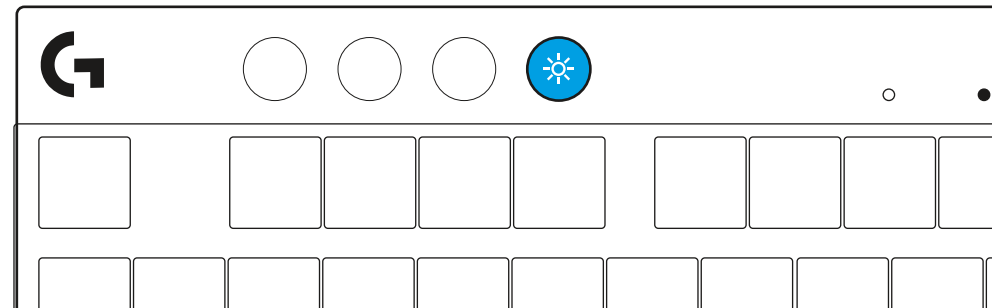

온보드 조명 효과

키보드의 온보드 메모리에 8개의 다양한 조명 효과가 저장되어 있습니다. 밝기 버튼과 다음 키를 눌러 선택 및 편집할 수 있습니다.

밝기 + 1 = 무지개 > 오른쪽

밝기 + 2 = 무지개 > 왼쪽

밝기 + 3 = 무지개 중앙

밝기 + 4 = 무지개 ^ 위로

밝기 + 5 = 컬러 순환

밝기 + 6 = 키 입력 반응

밝기 + 7 = 청록색 일렁임

밝기 + 8 = 커스텀 조명 효과

밝기 + 9 = 커스텀 조명 효과

밝기 + 0 = 청록색 유지

밝기 + - = 애니메이션 느리게

밝기 + = = 애니메이션 빠르게

G HUB 조명 컨트롤은 이 설정을 덮어씁니다.

LIGHTSPEED 무선 및 **BLUETOOTH®** 장치 전환

다른 연결 장치에서 입력하고 싶은 경우, 연결 상태에서 LIGHTSPEED 버튼을 눌러 LIGHTSPEED 연결을 선택하거나 Bluetooth® 버튼으로 Bluetooth® 연결을 선택합니다.

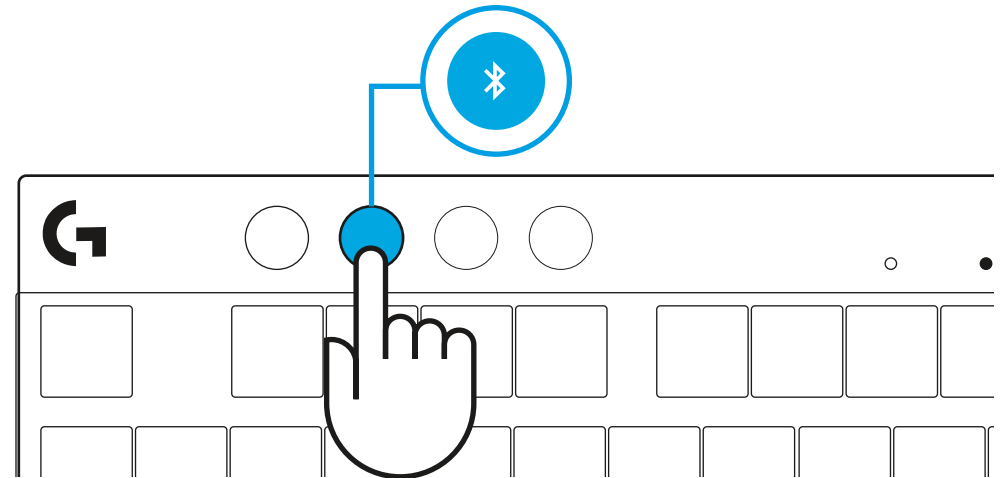
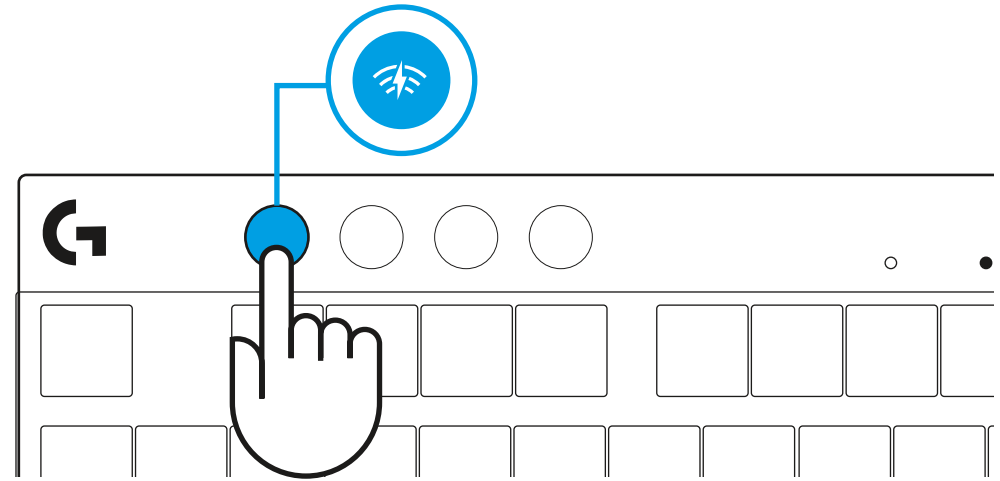



©2023 Logitech. Logitech, Logitech G, Logi and their respective logos are trademarks or registered trademarks of Logitech Europe S.A. and/or its affiliates in the U.S. and other countries. All other trademarks are the property of their respective owners. Logitech assumes no responsibility for any errors that may appear in this manual. Information contained herein is subject to change without notice. The *Bluetooth*® word mark and logos are registered trademarks owned by Bluetooth SIG, Inc. and any use of such marks by Logitech is under license.

版权所有 © 2023 罗技。罗技、罗技 G、Logi、Logitech、Logitech G 及其各自标志为 Logitech Europe S.A. 和/或其在美国及其他国家附属公司的商标或注册商标。所有其它商标均是其各自所有者的财产。罗技对于本手册中可能出现的任何错误不承担任何责任。本手册中包含的信息如有更改，恕不事先通知。蓝牙™ 文字商标和标志为 Bluetooth SIG, Inc. 所有的注册商标，罗技对此类商标和标志的所有使用均已获得授权。

WEB-621-002317 002